

CONFIDENTIAL AND PRIVILEGED

LIMITED ASBESTOS AND LEAD SURVEY

Encino/Balboa Golf Course

Los Angeles County
City of Los Angeles
State of California

October 19, 2003
Volume I of I

Prepared for:

CITY OF LOS ANGELES
Department of Recreation & Parks
205 S. Broadway, Room 820
Los Angeles, CA 90012

This report was prepared for the City of Los Angeles, by independent consultants and is based, in part, on information not within the control of either the City of Los Angeles, or the consultants. While it is believed that all information contained herein will be reliable under the conditions and subject to the limitations set forth herein, neither the City of Los Angeles, nor the consultants guarantee the accuracy thereof. The use of this report, or any information contained herein, shall be at the user's sole risk, regardless of any fault or negligence of the City of Los Angeles, or the consultants. Use of this report or any information contained herein shall constitute a release and agreement to defend and indemnify the City of Los Angeles, and consultants from and against all liability (including, but not limited to, liability for special, indirect or consequential damages) whether arising in contract or due to the City of Los Angeles, and/or consultant's negligence, strict liability or otherwise.

NATIONAL  ECON
C O R P O R A T I O N

730 EL CAMINO REAL
TUSTIN, CALIFORNIA, 92780
PHONE (714) 730-9235 FAX (714) 730-9236
EMAIL: NATIONALCONCORP@EARTHLINK.NET

October 19, 2003

City of Los Angeles
Department of Recreation and Parks
205 S. Broadway, Room 820
Los Angeles, CA 90012

Attn: Ms. Leila Barker
Environmental Supervisor

Re: Encino/Balboa Golf Course
Los Angeles, California

Dear Ms. Barker:

Pursuant to your request, National Econ Corporation's Representative, Mr. John Neiman (Certified Site Surveillance Technician #02-3145) has completed an Asbestos Survey on August 19 and 20, 2003 and September 2, 2003 at the Encino/Balboa Golf Course, Los Angeles, California. The following report summarizes the findings of this assessment.

1.0 INTRODUCTION

This report summarizes the findings of National Econ Corporation's Asbestos Survey of the Encino/Balboa Golf Course (subject property/site) in Los Angeles, California. This survey was performed at the request of the City of Los Angeles.

2.0 PURPOSE AND SCOPE OF SERVICES

Asbestos Surveys are performed to identify visible and/or readily accessible suspect friable and non-friable Asbestos Containing Building Materials (ACBMs) at a subject property. Friable ACBM as defined by the U.S. Environmental Protection Agency (EPA) and South Coast Air Quality Management District (SCAQMD) is material that when dry, can be easily pulverized, crushed or reduced to powder by hand pressure. Non-friable ACBM that can potentially be broken, crumbled, pulverized or reduced to powder in the course of demolition or renovation activities, are classified as either Class I or Class II, non-friable ACBM. These surveys are typically accomplished by, and limited to, a cursory site reconnaissance, a review of readily available building records, and a review of readily available asbestos Operation and Maintenance (O&M) plans.

In the event that suspected or known ACBMs exist at a given site, samples of the potential ACBMs may be obtained and analyzed. If, based upon the results of the Asbestos Survey, the presence of ACBMs are confirmed, recommendations for further investigations to evaluate the quantity and characteristics of these ACBMs and/or to manage their impact are required.

This Asbestos Survey was conducted in accordance with the Scope of Services authorized by the City of Los Angeles.

3.0 HISTORICAL DATA

Prior asbestos related documentation for the subject property was reviewed when made available.

4.0 VISUAL SURVEY AND SAMPLING METHODOLOGY

To identify suspected friable and non-friable ACBM, as required under California law, California Occupational Safety Health Administration (CAL-OSHA), Certified Site Surveillance Technicians (CSST) and/or Certified Asbestos Consultants (CAC) conducted a visual inspection and survey of the subject property.

During the survey National Econ Corporation identified homogeneous areas of suspected ACBMs for purposes of sampling in accordance with current CAL-OSHA requirements. These areas were defined with respect to similarities in appearance, age, use, type, color, and/or texture. The condition and estimated quantity of the suspected materials were also assessed. Based upon National Econ Corporation's observations, twenty-one (21) homogeneous materials of suspected ACBMs were identified. The materials in these areas included cement board panel, stucco, plaster, built-up roofing, roof mastic, window putty, acoustical spray-on, drywall (composite), cove base and mastic.

To evaluate the presence of asbestos in these suspected ACBMs, National Econ Corporation obtained sixty-eight (68) bulk samples which appeared to represent each homogeneous area (see Table I). The sample locations are shown on the attached drawings.

Amended water-spray wet methods were used during the collection of each friable sample, such as suspended ceiling tiles. National Econ Corporation does not conduct destructive sampling. For example, samples of floor tile were collected by taking a small chip out of a corner or area which was already damaged. After obtaining each sample, the sampling equipment was cleaned with a moist towelette. Each sample was sealed in a sample container and assigned a discrete sample identification number.

5.0 ANALYTICAL PROCEDURES AND RESULTS

All sixty-eight (68) samples obtained from the subject property were delivered to Scientific Laboratories of California, Inc., (under chain-of-custody procedures) for analysis. Scientific Laboratories of California, Inc., is accredited by the National Institute of Standards and Technology (NIST) through participation in the National Voluntary Laboratory Accreditation Program (NVLAP Lab #200346-0). The samples were analyzed for asbestos by PLM, using dispersion staining in accordance with U.S. EPA Procedures outlined in 40 CFR 763, Subpart F, Appendix A (AHERA). Asbestos volume estimates were made by the laboratory analyst using a stereomicroscope.

Based upon the analytical results, asbestos is present in twenty-four (24) of the samples analyzed, twenty-one (21) of which are non-friable material. These samples were obtained from stucco, roof mastic, plaster, window putty, acoustical spray-on and cement board.

Asbestos content of less than 1% (which is the federal standard utilized by testing laboratories) is detectable only in trace quantities utilizing PLM methods. The California (CAL/OSHA) definition of ACM is materials that contain 0.1% of asbestos or any detectable asbestos must comply with all applicable provisions. A more definitive analytical method, such as Transmission Electron Microscopy (TEM) analysis, which is capable of detecting asbestos below 1% and analysis of materials that are difficult to analyze through routine PLM analysis is available upon request. TEM analysis is often recommended in samples such as floor tile, which is found to be negative for asbestos content through PLM analysis.

6.0 DISCUSSION

A total of sixty-eight (68) bulk material samples were collected from the Encino/Balboa Golf Course, Los Angeles, California, during the survey. Sixty-five (65) of the sixty-eight (68) samples collected are considered non-friable.

Based upon the analytical results, asbestos is present in the stucco, roof mastic, plaster, window putty, acoustical spray-on and cement board. The ACBM in these compounds is in good to fair condition and five (5) are considered non-friable. However, these materials may become friable if damaged or disturbed, i.e.: removal, chipping, etc. A summary of the friability evaluations, condition ratings and material accessibility for positive samples is presented in Table I.

7.0 CONCLUSIONS

The building materials identified as asbestos containing material by this assessment are in good to fair condition and five (5) are considered to be non-friable. These materials have a low potential for future disturbance if they are not damaged or disturbed, i.e.: removal, chipping, etc.

8.0 RECOMMENDATIONS

Due to the potential hazards of exposure, an Asbestos Management Program (AMP) should be prepared, and implemented, to avoid incidental, and/or accidental disturbance of ACM. The AMP should set forth operational and maintenance guidelines to minimize fiber release which may be caused by age, normal wear and tear, delamination, building maintenance, repairs, renovation and other activities which may disturb ACM.

Prior to demolition, or major construction, specifications should be properly modified to incorporate the removal of ACM.

If removal of ACBM is required in connection with demolition, renovation, or building repair, such work should only be performed by personnel who are appropriately trained, experienced, and registered. Intentional disturbance of ACBM should be performed in a manner such that emissions are controlled. Control measures should include, but not be limited to, wet methods, encapsulation, removal with HEPA-filter equipped vacuums, and appropriately labeled polyethylene bags. HVAC systems in work areas where asbestos is to be abated should be deactivated and the register closed and temporarily sealed. Air monitoring relating to such work should be performed by or under the direct supervision of a California State Certified Asbestos Consultant before, during, and after the abatement work, as required by EPA and other regulations.

California law requires a building owner to provide tenant, employee and vendor notification within fifteen (15) days of receipt of information identifying the presence of ACBM in their building(s) and annually thereafter. Specific notification requirements are outlined in Assembly Bill 3713.

There are potential liabilities associated with the presence, and removal, of ACM. Precautionary measures, as outlined herein, should be taken in accordance with the guidelines set forth by the EPA, the Occupational Safety and Health Administration (OSHA) and other regulatory agencies.

9.0 LIMITATIONS

The conclusions presented in this report are professional opinions based solely upon visual observations at the site and laboratory analysis of the tested samples. They are intended exclusively for the purpose outlined herein, and for the site location and project indicated.

This report is intended for the sole use of the City of Los Angeles. The use or re-use of this document or the findings, conclusion or recommendations presented herein, by any other party or parties is at the sole risk of said user.

Recognizing that even the most comprehensive survey may fail to detect ACBM at a particular site, this study was not intended to identify all potential ACBM present in the building or at the site for such reasons as (1) the possible existence of buried, covered and inaccessible areas and features; and (2) the limited number of samples collected. Samples were collected from materials of similar appearance, age, use, type, color and/or texture. However, this does not guarantee that they are of the same composition. No guarantee is expressed or implied that all ACBM has been identified. National Econ Corporation assumes no responsibility for the identification of suspect asbestos containing materials which are concealed and/or inaccessible (i.e. carpet mastic under carpet, locked rooms, etc.)

Services performed by National Econ Corporation were conducted in a manner consistent with that of the care and skill ordinarily and currently exercised by members of the same profession that even the most comprehensive Scope of Services might fail to detect environmental liabilities on a particular site. Therefore, National Econ Corporation cannot act as insurers and cannot "certify" that a site is free of environmental contamination.

No expressed or implied representation or warranty is included or intended in our reports, except that our services were performed, within the limits prescribed by the Scope of Services, with the customary thoroughness and competence of our profession.

Information and opinions presented herein apply to the existing and reasonable foreseeable site conditions at the time of our investigation. They cannot necessarily apply to site changes of which this office is unaware and has not had the opportunity to review. Changes in the conditions of this property may occur with time due to natural processes or works of man on the subject property or on adjacent properties. Changes in applicable standards may also occur as a result of legislation of the broadening of knowledge. Accordingly, the findings of this report may be invalidated, wholly or in part, by changes beyond our control.

National Econ Corporation trusts that the information presented herein provides the data you require. Should you have any questions or comments, please contact National Econ Corporation.

Respectfully submitted,

NATIONAL ECON CORPORATION



Danny De La Rosa
Vice President of Operations
Certified Asbestos Consultant
#95-1601

Attachments:

Table I:
Drawing: Asbestos Sample Location Diagram
Laboratory Analytical Results

**TABLE I
SURVEY SUMMARY**

CLIENT: City of Los Angeles
 LOCATION: Encino/Balboa Golf Course, Los Angeles, CA – BUILDING A
 DATE: October 19, 2003
 SHEET: 1 of 1

SAMPLE NUMBER	MATERIAL DESCRIPTION	MATERIAL LOCATION	HOMO (1)	ASBESTOS TYPE FOUND	%	S/T/M (2)	F/NF (3)	CONDITION	ACCESSIBILITY	ESTIMATED QUANTITY
EB-A-01	Cement Board Panel	Men's Restroom	Y	None Detected	N/A	N/A	N/A	N/A	N/A	N/A
EB-A-02	Cement Board Panel	Women's Restroom	Y	None Detected	N/A	N/A	N/A	N/A	N/A	N/A
EB-A-03	Stucco	Building Exterior	Y	None Detected	N/A	N/A	N/A	N/A	N/A	N/A
EB-A-04	Stucco	Building Exterior	Y	Chrysotile	20	S	NF	GOOD	HIGH	550 SQ. FT.
EB-A-05	Stucco	Building Exterior	Y	Chrysotile	20	S	NF	GOOD	HIGH	REF #04
EB-A-06	Plaster Wall	Men's Restroom	Y	None Detected	N/A	N/A	N/A	N/A	N/A	N/A
EB-A-07	Plaster Wall	Men's Restroom	Y	None Detected	N/A	N/A	N/A	N/A	N/A	N/A
EB-A-08	Plaster Wall	Women's Restroom	Y	None Detected	N/A	N/A	N/A	N/A	N/A	N/A
EB-A-09	Built-Up Roofing (Cap Sheet)	Roof	Y	None Detected	N/A	N/A	N/A	N/A	N/A	N/A
EB-A-10	Built-Up Roofing (Cap Sheet)	Roof	Y	None Detected	N/A	N/A	N/A	N/A	N/A	N/A
EB-A-11	Built-Up Roofing (Cap Sheet)	Roof	Y	None Detected	N/A	N/A	N/A	N/A	N/A	N/A
EB-A-12	Roof Mastic	Roof	Y	Chrysotile	7	M	NF	GOOD	HIGH	25 SQ. FT.
EB-A-13	Roof Mastic	Roof	Y	None Detected	N/A	N/A	N/A	N/A	N/A	N/A
EB-A-14	Roof Mastic	Roof	Y	Chrysotile	7	M	NF	GOOD	HIGH	REF #12

LEGEND:

(1) HOMO= Homogeneous Material
 (2) S= Surface Material
 T= Thermal System Insulation
 M= Miscellaneous Material
 (3) F= Friable
 NF= Non-Friable

NOTE: Unless otherwise specified, sample results above were determined by Polarized Light Microscopy (PLM) with dispersion staining

**TABLE I
SURVEY SUMMARY**

CLIENT: City of Los Angeles
 LOCATION: Encino/Balboa Golf Course, Los Angeles, CA – BUILDING B
 DATE: October 19, 2003
 SHEET: 1 of 1

SAMPLE NUMBER	MATERIAL DESCRIPTION	MATERIAL LOCATION	HOMO (1)	ASBESTOS TYPE FOUND	%	S/T/M (2)	F/NF (3)	CONDITION	ACCESSIBILITY	ESTIMATED QUANTITY
EB-A-01	Ceiling Plaster	Men's Restroom Center	Y	Chrysotile	<1	M	NF	FAIR	HIGH	1,000 SQ. FT.
EB-A-02	Ceiling Plaster	Women's Restroom NE Area	Y	Chrysotile	<1	M	NF	FAIR	HIGH	REF #01
EB-A-03	Ceiling Plaster	Women's Restroom NE Area	Y	Chrysotile	3	M	NF	FAIR	HIGH	REF #01
EB-A-04	Stucco	Building Exterior SE Area	Y	None Detected	N/A	N/A	N/A	N/A	N/A	N/A
EB-A-05	Stucco	Building Exterior SE Area	Y	None Detected	N/A	N/A	N/A	N/A	N/A	N/A
EB-A-06	Stucco	Building Exterior NW Area	Y	None Detected	N/A	N/A	N/A	N/A	N/A	N/A
EB-A-07	Window Putty	Building Exterior SE Area	Y	Chrysotile	<1	M	NF	FAIR	HIGH	100 LF
EB-A-08	Window Putty	Building Exterior Mid. S Area	Y	Chrysotile	<1	M	NF	FAIR	HIGH	REF #07
EB-A-09	Window Putty	Building Exterior SW Area	Y	Chrysotile	<1	M	NF	FAIR	HIGH	REF #07

LEGEND:

- (1) HOMO= Homogeneous Material
 (2) S= Surface Material
 T= Thermal System Insulation
 M= Miscellaneous Material
 (3) F= Friable
 NF= Non-Friable

NOTE: Unless otherwise specified, sample results above were determined by Polarized Light Microscopy (PLM) with dispersion staining

**TABLE I
SURVEY SUMMARY**

CLIENT: City of Los Angeles
 LOCATION: Encino/Balboa Golf Course, Los Angeles, CA – BUILDING C
 DATE: October 19, 2003
 SHEET: 1 of 1

SAMPLE NUMBER	MATERIAL DESCRIPTION	MATERIAL LOCATION	HOMO (1)	ASBESTOS TYPE FOUND	%	S/T/M (2)	F/NF (3)	CONDITION	ACCESSIBILITY	ESTIMATED QUANTITY
EB-A-01	Ceiling Plaster	Women's Restroom NW Area	Y	Chrysotile	<1	M	NF	GOOD	HIGH	1,500 SQ. FT.
EB-A-02	Ceiling Plaster	Men's Restroom SW Area	Y	Chrysotile	<1	M	NF	GOOD	HIGH	REF #01
EB-A-03	Ceiling Plaster	Men's Restroom Mid. S Area	Y	Chrysotile	<1	M	NF	GOOD	HIGH	REF #01
EB-A-04	Stucco	Arcade NE Area	Y	Chrysotile	<1	M	NF	GOOD	HIGH	400 SQ. FT.
EB-A-05	Stucco	Arcade SW Area	Y	Chrysotile	<1	M	NF	GOOD	HIGH	REF #04
EB-A-06	Stucco	Arcade SE Area	Y	Chrysotile	<1	M	NF	GOOD	HIGH	REF #04

LEGEND:

- (1) HOMO= Homogeneous Material
- (2) S= Surface Material
 T= Thermal System Insulation
 M= Miscellaneous Material
- (3) F= Friable
 NF= Non-Friable

NOTE: Unless otherwise specified, sample results above were determined by Polarized Light Microscopy (PLM) with dispersions staining.

**TABLE I
SURVEY SUMMARY**

CLIENT: City of Los Angeles
 LOCATION: Encino/Balboa Golf Course, Los Angeles, CA – BUILDING D
 DATE: October 19, 2003
 SHEET: 1 of 1

SAMPLE NUMBER	MATERIAL DESCRIPTION	MATERIAL LOCATION	HOMO (1)	ASBESTOS TYPE FOUND	%	S/T/M (2)	F/NF (3)	CONDITION	ACCESSIBILITY	ESTIMATED QUANTITY
EB-A-07	Acoustical Spray-On	Men's Locker Room NW Area	Y	Chrysotile	7	S	F	GOOD	HIGH	4,000 SQ. FT.
EB-A-08	Acoustical Spray-On	Men's Locker Room NW Area	Y	Chrysotile	7	S	F	GOOD	HIGH	REF #07
EB-A-09	Acoustical Spray-On	Women's Locker Room SE Area	Y	Chrysotile	7	S	F	GOOD	HIGH	REF #07
EB-A-10	Drywall (Composite)	Men's Locker Room NE Area	Y	None Detected	N/A	N/A	N/A	N/A	N/A	N/A
EB-A-11	Drywall (Composite)	Men's Locker Room SE Area	Y	None Detected	N/A	N/A	N/A	N/A	N/A	N/A
EB-A-12	Drywall (Composite)	Women's Locker Room NE Area	Y	None Detected	N/A	N/A	N/A	N/A	N/A	N/A
EB-A-13A	Cove Base	Men's Locker Room NE Area	Y	None Detected	N/A	N/A	N/A	N/A	N/A	N/A
EB-A-13B	Cove Base Mastic	Men's Locker Room NE Area	Y	None Detected	N/A	N/A	N/A	N/A	N/A	N/A
EB-A-14A	Cove Base	Men's Locker Room NW Area	Y	None Detected	N/A	N/A	N/A	N/A	N/A	N/A
EB-A-14B	Cove Base Mastic	Men's Locker Room NW Area	Y	None Detected	N/A	N/A	N/A	N/A	N/A	N/A
EB-A-15A	Cove Base	Men's Locker Room SW Area	Y	None Detected	N/A	N/A	N/A	N/A	N/A	N/A
EB-A-15B	Cove Base Mastic	Men's Locker Room SW Area	Y	None Detected	N/A	N/A	N/A	N/A	N/A	N/A

LEGEND:

- (1) HOMO= Homogeneous Material
 - (2) S= Surface Material
 T= Thermal System Insulation
 M= Miscellaneous Material
 - (3) F= Friable
 NF= Non-Friable
- NOTE:** Unless otherwise specified, sample results above were determined by Polarized Light Microscopy (PLM) with disnersion staining

**TABLE I
SURVEY SUMMARY**

CLIENT: City of Los Angeles
 LOCATION: Encino/Balboa Golf Course, Los Angeles, CA – BUILDING E
 DATE: October 19, 2003
 SHEET: 1 of 1

SAMPLE NUMBER	MATERIAL DESCRIPTION	MATERIAL LOCATION	HOMO (1)	ASBESTOS TYPE FOUND	%	S/T/M (2)	F/NF (3)	CONDITION	ACCESSIBILITY	ESTIMATED QUANTITY
EB-A-01	Plaster	Men's Restroom NW Area	Y	None Detected	N/A	N/A	N/A	N/A	N/A	N/A
EB-A-02	Plaster	Men's Restroom NW Area	Y	None Detected	N/A	N/A	N/A	N/A	N/A	N/A
EB-A-03	Plaster	Men's Restroom Mid. W Area	Y	None Detected	N/A	N/A	N/A	N/A	N/A	N/A
EB-A-04	Stucco	Building Exterior SE Area	Y	None Detected	N/A	N/A	N/A	N/A	N/A	N/A
EB-A-05	Stucco	Building Exterior NE Area	Y	None Detected	N/A	N/A	N/A	N/A	N/A	N/A
EB-A-06	Stucco	Building Exterior NW Area	Y	None Detected	N/A	N/A	N/A	N/A	N/A	N/A
EB-A-07	Cement Board	Building Exterior	Y	Chrysotile	40	M	NF	GOOD	HIGH	200 SQ. FT.
EB-A-08A	Built-Up Roofing (Cap Sheet)	Roof SE Area	Y	None Detected	N/A	N/A	N/A	N/A	N/A	N/A
EB-A-08B	Built-Up Roofing (2 nd Layer)	Roof SE Area	Y	None Detected	N/A	N/A	N/A	N/A	N/A	N/A
EB-A-09A	Built-Up Roofing (Cap Sheet)	Roof Center	Y	None Detected	N/A	N/A	N/A	N/A	N/A	N/A
EB-A-09B	Built-Up Roofing (2 nd Layer)	Roof Center	Y	None Detected	N/A	N/A	N/A	N/A	N/A	N/A
EB-A-10A	Built-Up Roofing (Cap Sheet)	Roof NW Area	Y	None Detected	N/A	N/A	N/A	N/A	N/A	N/A
EB-A-10B	Built-Up Roofing (2 nd Layer)	Roof NW Area	Y	None Detected	N/A	N/A	N/A	N/A	N/A	N/A
EB-A-11	Roof Mastic	Roof SE Area	Y	None Detected	N/A	N/A	N/A	N/A	N/A	N/A
EB-A-12	Roof Mastic	Roof NW Area	Y	None Detected	N/A	N/A	N/A	N/A	N/A	N/A
EB-A-13	Roof Mastic	Roof SW Area	Y	Chrysotile	7	M	NF	GOOD	HIGH	50 SQ. FT.

LEGEND:

- (1) HOMO= Homogeneous Material
 (2) S= Surface Material
 T= Thermal System Insulation
 M= Miscellaneous Material
 (3) F= Friable
 NF= Non-Friable
- NOTE:** Unless otherwise specified, sample results above were determined by Polarized Light Microscopy (PLM) with dispersion staining

**TABLE I
SURVEY SUMMARY**

CLIENT: City of Los Angeles
 LOCATION: Encino/Balboa Golf Course, Los Angeles, CA – BUILDING F
 DATE: October 19, 2003
 SHEET: 1 of 1

SAMPLE NUMBER	MATERIAL DESCRIPTION	MATERIAL LOCATION	HOMO (1)	ASBESTOS TYPE FOUND	%	S/T/M (2)	F/NF (3)	CONDITION	ACCESSIBILITY	ESTIMATED QUANTITY
EB-A-01	Built-Up Roofing (Rock)	Roof Mid. S Area	Y	None Detected	N/A	N/A	N/A	N/A	N/A	N/A
EB-A-02	Built-Up Roofing (Rock)	Roof Center	Y	None Detected	N/A	N/A	N/A	N/A	N/A	N/A
EB-A-03	Built-Up Roofing (Rock)	Roof NE Area	Y	None Detected	N/A	N/A	N/A	N/A	N/A	N/A
EB-A-04	Roof Mastic	Roof Mid. S Area	Y	Chrysotile	5	M	NF	GOOD	HIGH	20 SQ. FT.
EB-A-05	Roof Mastic	Roof Mid. N Area	Y	Chrysotile	5	M	NF	GOOD	HIGH	REF #04
EB-A-06	Roof Mastic	Roof Center	Y	Chrysotile	5	M	NF	GOOD	HIGH	REF #04
EB-A-07	Wall Plaster	Women's Restroom 1 st Stall	Y	None Detected	N/A	N/A	N/A	N/A	N/A	N/A
EB-A-08	Wall Plaster	Women's Restroom 2 nd Stall	Y	None Detected	N/A	N/A	N/A	N/A	N/A	N/A
EB-A-09	Wall Plaster	Men's Restroom	Y	None Detected	N/A	N/A	N/A	N/A	N/A	N/A

LEGEND:

- (1) HOMO= Homogeneous Material
 (2) S= Surface Material
 T= Thermal System Insulation
 M= Miscellaneous Material
 (3) F= Friable
 NF= Non-Friable

NOTE: Unless otherwise specified, sample results above were determined by Polarized Light Microscopy (PLM) with disnersion staining

Encino/Balboa Golf Course
Building A

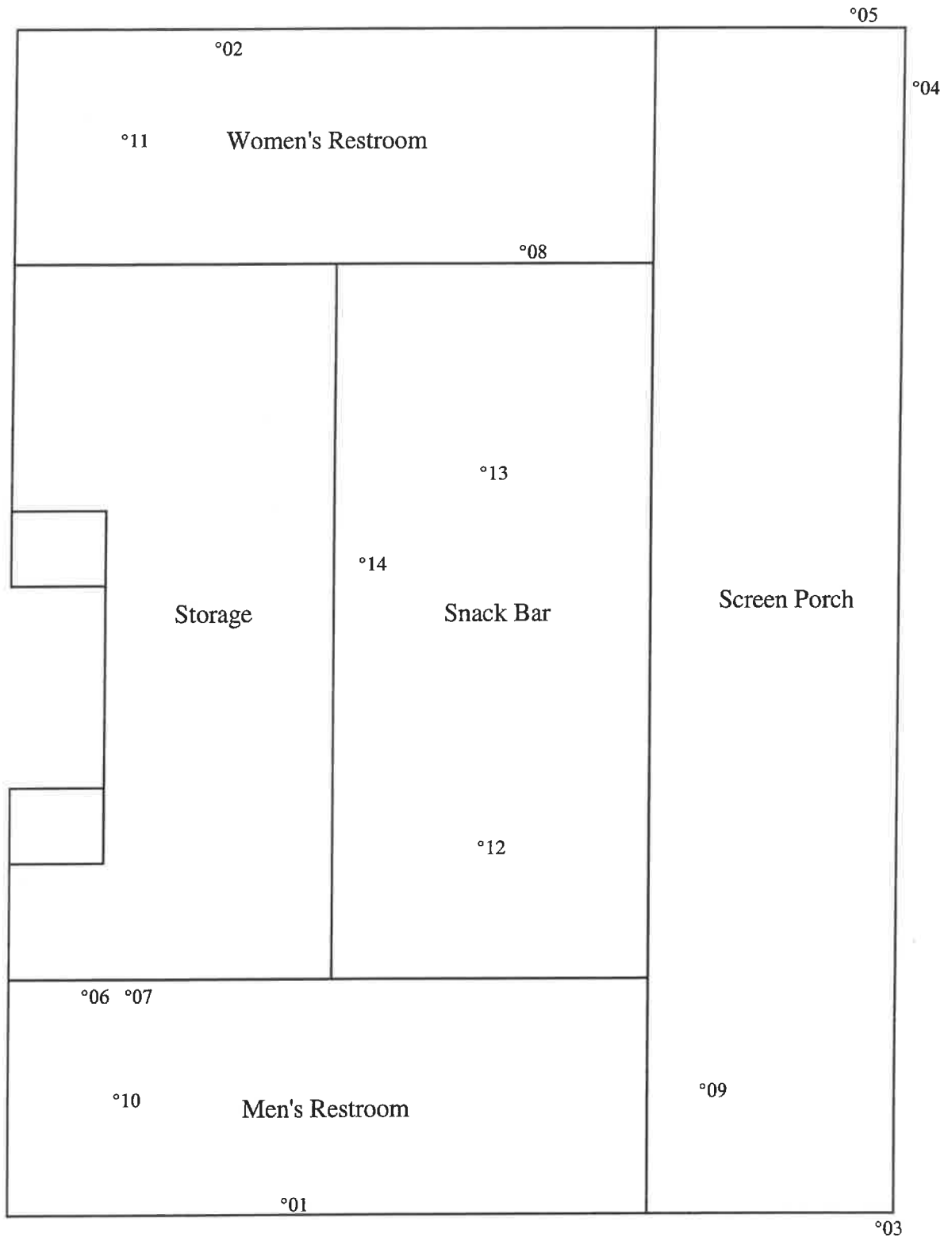

NOT TO SCALE

Encino/Balboa Golf Course
Building B

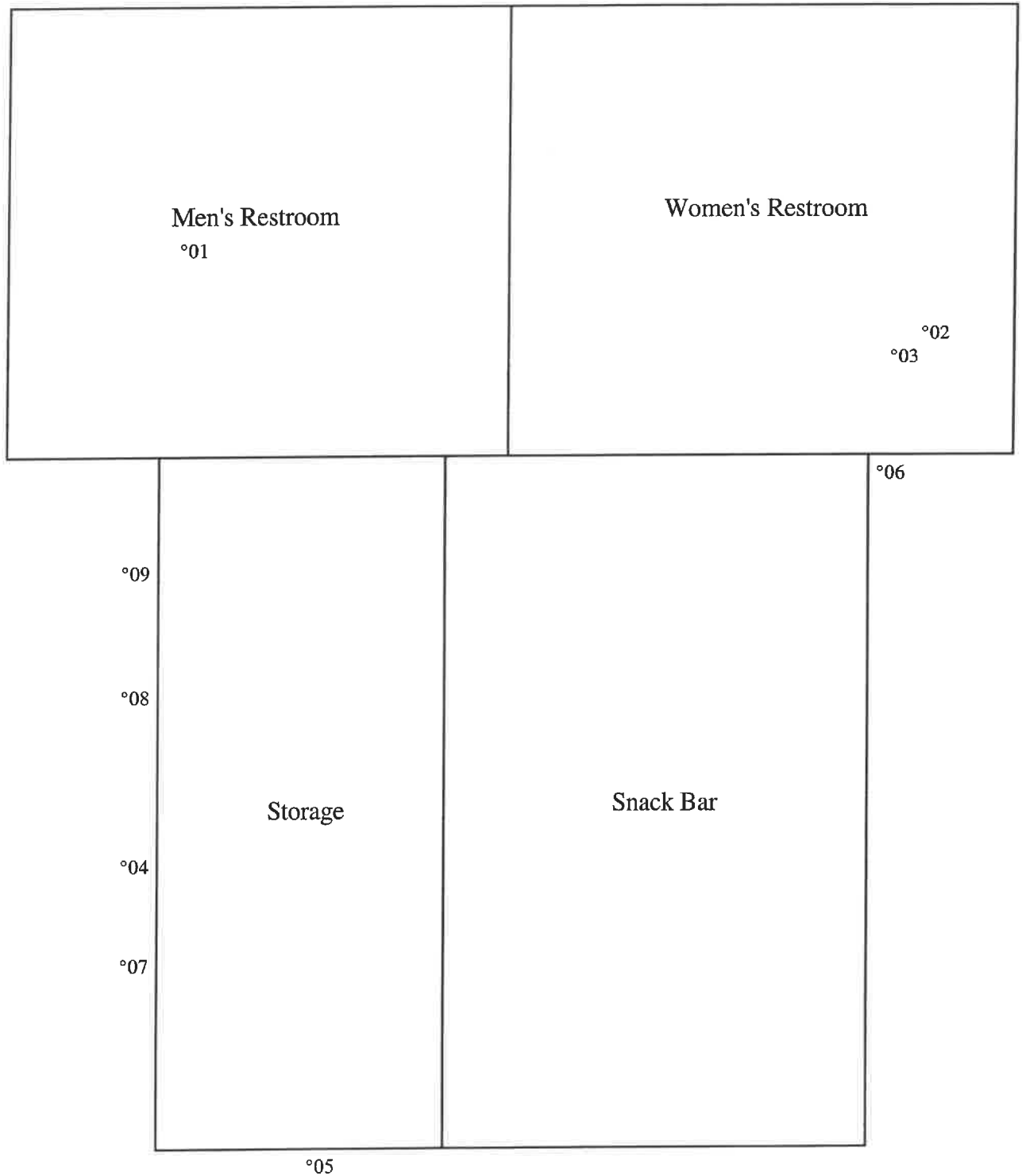

NOT TO SCALE

Encino/Balboa Golf Course
Building C

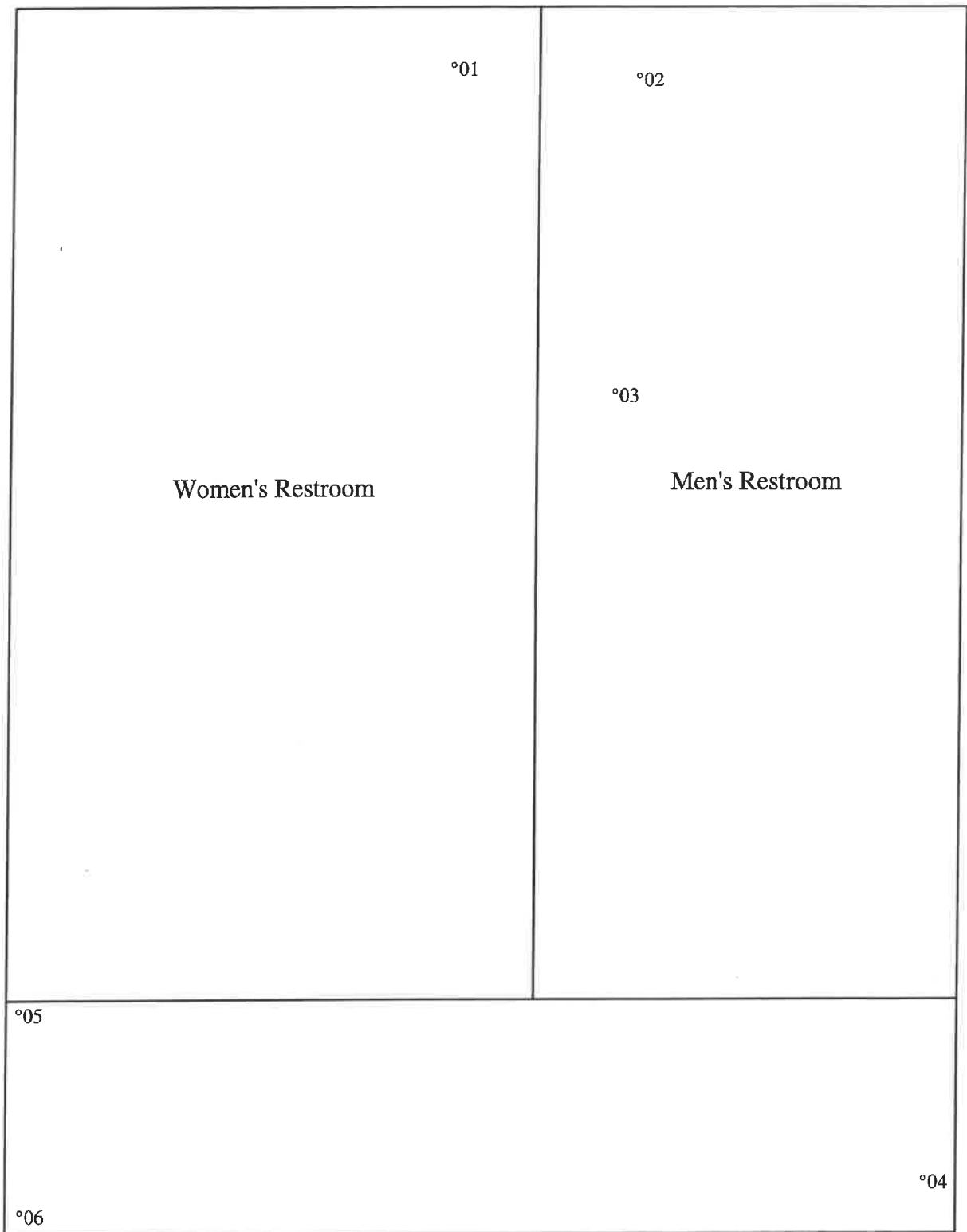

NOT TO SCALE

Encino/Balboa Golf Course
Building D

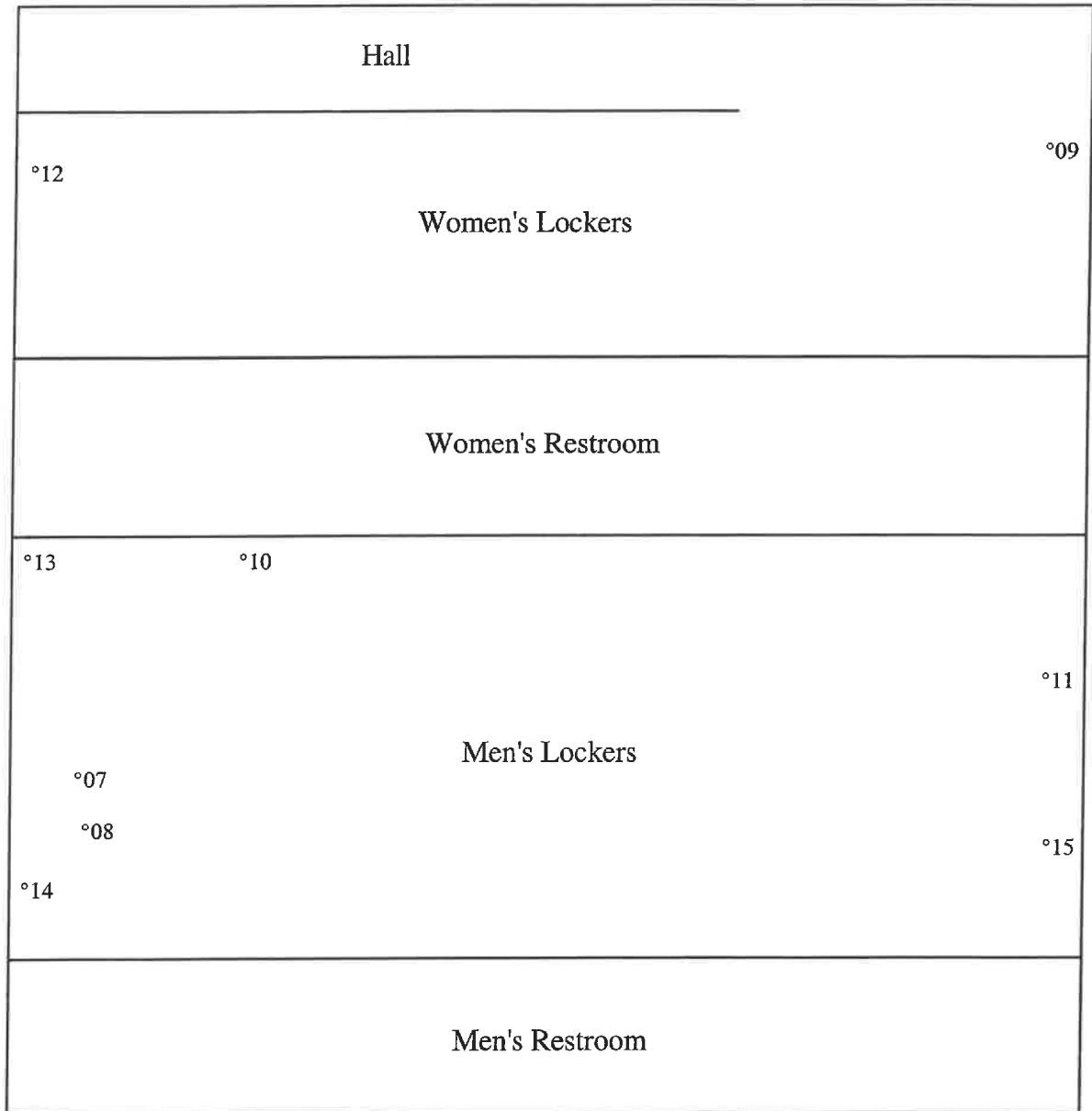

NOT TO SCALE

Encino/Balboa Golf Course
Building E



NOT TO SCALE

Encino/Balboa Golf Course
Building F

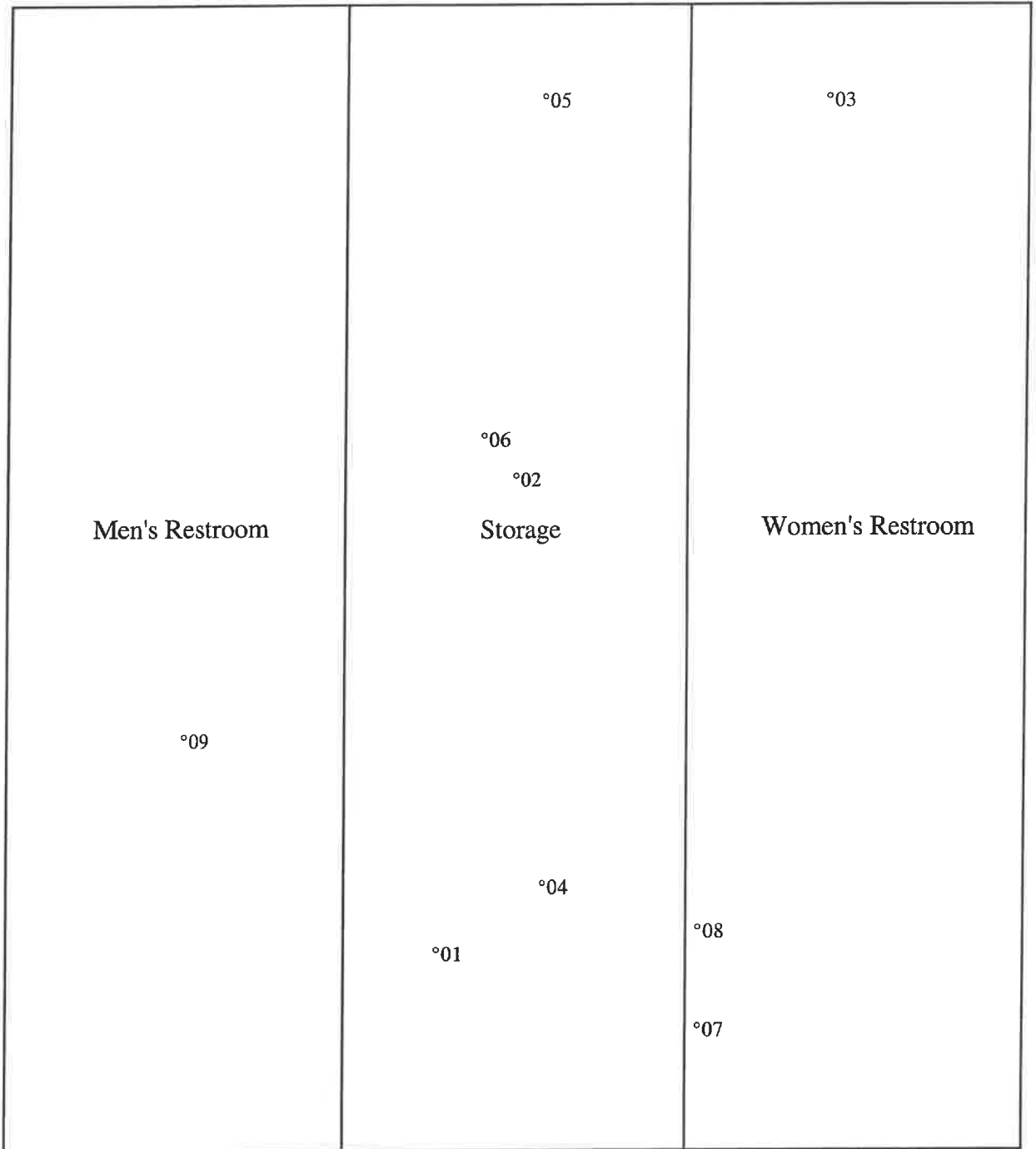

NOT TO SCALE

6.0 TESTING PROTOCOL

Testing was conducted in compliance with the HUD Guidelines published in 1997. Representative surfaces of each painted or varnished component were tested. Additionally, the exterior of the property was sampled in the same manner. The HUD level for lead containing material is 1.0 mg/cm². The City of Los Angeles' detection limit is 0.7 mg/cm².

7.0 SUMMARY OF RESULTS

Interior: Throughout these buildings, thirty-nine (39) of the two hundred thirty-three (233) readings of the interior painted components indicated the presence of lead containing material at or above the HUD level.

Twenty-six (26) of the thirty-nine (39) positive readings were found in ceramic tile. The surfaces were not painted and the lead is most likely in the glazing or the matrix of the tile itself.

Exterior: Of the one hundred twenty-one (121) exterior readings, twenty (20) reading indicated the presence of lead containing material at or above the HUD level.

Some surfaces may contain levels of lead below 0.7 mg/cm² which could create lead dust or lead-contaminated soil hazards, if the surface is turned into dust by abrasion, scrapping or sanding.

8.0 RECOMMENDATIONS

Due to the potential hazards of exposure, a Lead Management Program should, at minimum, be prepared, and implemented, to avoid incidental, and/or accidental disturbance of lead containing material, found at the Encino/Balboa Golf Course, Los Angeles, California. The program should set forth operational and maintenance guidelines to minimize lead consumption or exposure which may be caused by age, normal wear and tear, delamination, building maintenance, repairs, renovation and other activities which may impact lead containing material.

Prior to demolition, or major construction, specifications should be properly modified to incorporate the removal of lead containing material.

According to CAL-OSHA any detectable level of lead can result in occupational exposure.

Note that under Section 302 of the Lead-Based Paint Poisoning Prevention Act (LBPPPA), lead containing material hazards equal to or greater than 0.5% by weight (5,000 ppm) or 1.0 mg/cm² must be abated. Lead containing material that is intact and is not delaminating can be disposed of as construction debris as long as it is attached to its original substrate and are within waste characterization protocols. However, appropriate work practices and worker protection must be utilized.

National Econ Corporation recommends that personal and random area air monitoring be conducted during lead removal and/or demolition.

9.0 INSPECTION LIMITATIONS

This inspection was planned, developed, and implemented based on National Econ Corporation's previous experience in performing lead containing material inspections. This inspection was conducted in compliance with HUD protocols as published in September 1990. National Econ Corporation utilized state-of-the-art-practices and techniques in accordance with regulatory standards, while performing this inspection. National Econ Corporation's evaluation of the relative risk of exposure to lead, identified during this inspection, is based on conditions observed at the time of the inspection. National Econ Corporation cannot be responsible for changing conditions that may alter the relative exposure risk or for future changes in accepted methodology.

The floor plans (Not to Scale) and actual test results for each of the tested areas are contained within this report.

National Econ Corporation assumes no responsibility for the identification of "atypical" lead containing material, used in the construction trade.

There are potential liabilities associated with the presence, and removal, of lead containing material. Precautionary measures, as outlined herein, should be taken in accordance with the guidelines set forth by the EPA, the Occupational Safety and Health Administration (OSHA) and other regulatory agencies.

National Econ Corporation representatives are prepared to meet with your staff, to further discuss this project, upon your request.

Please feel free to call National Econ Corporation with any questions you may have in connection with the survey, contained herein.

Danny De La Rosa
Vice President of Operations
Certified Lead Inspector/Assessor #1652



National Econ Corporation

TABLE I
LEAD SURVEY SUMMARY

CLIENT: City of Los Angeles Parks & Recreation
LOCATION: Encino/Balboa Golf Course, Los Angeles, CA - BUILDING A

DATE: October 19, 2003
SHEET: 1 of 2

Sample #	Room/Area	Side	Component	Substrate	Color	Condition	Accessibility	CLC	Results	Quantity
01	Men's Restroom	A	Wall	Transite	Blue	Good	High	-0.2	Negative	N/A
02	Men's Restroom	A	Door	Wood	Brown	Good	High	-0.3	Negative	N/A
03	Men's Restroom	B	Wall	Concrete	Blue	Good	High	-0.1	Negative	N/A
04	Men's Restroom	B	Window Frame	Wood	White	Good	High	-0.1	Negative	N/A
05	Men's Restroom	B	Dispenser	Metal	White	Good	High	-0.1	Negative	N/A
06	Men's Restroom	C	Wall	Ceramic	Yellow	Good	High	8.6	Positive	N/A
07	Men's Restroom	C	Wall	Plaster	Blue	Good	High	-0.3	Negative	N/A
08	Men's Restroom	C	Sink	Porcelain	White	Good	High	-0.4	Negative	N/A
09	Men's Restroom	C	Urinal	Porcelain	White	Good	High	-0.4	Negative	N/A
10	Men's Restroom	C	Partition Wall	Metal	Green	Good	High	-0.1	Negative	N/A
11	Men's Restroom	C	Partition Post	Metal	Green	Good	High	-0.2	Negative	N/A
12	Men's Restroom	C	Toilet	Porcelain	White	Good	High	-0.2	Negative	N/A
13	Men's Restroom	D	Wall	Concrete	Blue	Good	High	-0.3	Negative	N/A
14	Men's Restroom	D	Partition Wall	Metal	Green	Good	High	-0.1	Negative	N/A
15	Men's Restroom	D	Partition Post	Metal	Green	Good	High	-0.3	Negative	N/A
16	Men's Restroom	--	Floor	Ceramic	Tan	Good	High	-0.2	Negative	N/A
17	Women's Restroom	A	Wall	Ceramic	Yellow	Good	High	>9.9	Positive	N/A
18	Women's Restroom	A	Wall	Plaster	Pink	Good	High	-0.1	Negative	N/A
19	Women's Restroom	A	Sink	Porcelain	White	Good	High	-0.1	Negative	N/A
20	Women's Restroom	A	Dispenser	Metal	White	Good	High	-0.2	Negative	N/A
21	Women's Restroom	A	Toilet	Porcelain	White	Good	High	-0.3	Negative	N/A
22	Women's Restroom	A	Partition Wall	Metal	Green	Good	High	-0.2	Negative	N/A
23	Women's Restroom	A	Partition Post	Metal	Green	Good	High	-0.2	Negative	N/A
24	Women's Restroom	B	Wall	Concrete	Pink	Good	High	-0.2	Negative	N/A
25	Women's Restroom	B	Partition	Metal	Green	Good	High	-0.2	Negative	N/A
26	Women's Restroom	C	Wall	Transite	Pink	Good	High	-0.6	Negative	N/A
27	Women's Restroom	C	Door	Wood	Brown	Good	High	-0.2	Negative	N/A
28	Women's Restroom	D	Wall	Concrete	Pink	Good	High	-0.3	Negative	N/A
29	Building Exterior	A	Wall	Stucco	Tan	Good	High	0.1	Negative	N/A
30	Building Exterior	A	Wall	Concrete	Tan	Good	High	-0.2	Negative	N/A
31	Building Exterior	A	Door	Wood	Brown	Good	High	-0.3	Negative	N/A
32	Building Exterior	A	Beam	Metal	Brown	Good	High	-0.1	Negative	N/A
33	Building Exterior	A	Window Sill	Wood	Brown	Good	High	-0.2	Negative	N/A
34	Building Exterior	A	Window Frame	Wood	Brown	Good	High	-0.2	Negative	N/A
35	Building Exterior	A	Door	Wood	Brown	Good	High	-0.1	Negative	N/A
36	Building Exterior	A	Wall	Transite	Tan	Good	High	0.3	Negative	N/A
37	Building Exterior	A	Wall	Metal	Tan	Good	High	-0.2	Negative	N/A

LEGEND:

HUD Definitions:

HUD level for lead paint = 1.0 mg/cm².

Positive = XRF sampling with levels above 1.2 mg/cm².

Inconclusive = XRF sampling with levels between 0.8 and 1.2 mg/cm².

CLC = Corrected Lead Concentration.

Accessibility:

High - Accessible to a minor child (60" from base).

Medium - Can be accessible to a minor child.

Low - Is not accessible to a minor child.

Condition:

Good - Surface intact with no delamination or chipping.

Fair - Some minor damage.

Poor - Widespread chipping, damage and/or delamination.

TABLE I
LEAD SURVEY SUMMARY

CLIENT: City of Los Angeles Parks & Recreation
LOCATION: Encino/Balboa Golf Course, Los Angeles, CA - BUILDING A

DATE: October 19, 2003
SHEET: 2 of 2

Sample #	Room/Area	Side	Component	Substrate	Color	Condition	Accessibility	CLC	Results	Quantity
38	Building Exterior	A	Wall	Transite	Tan	Good	High	0.3	Negative	N/A
39	Building Exterior	A	Wall	Metal	Tan	Good	High	-0.2	Negative	N/A
40	Building Exterior	A	Fence	Metal	Brown	Good	High	0.1	Negative	N/A
41	Building Exterior	B	Wall	Concrete	Tan	Good	High	-0.4	Negative	N/A
42	Building Exterior	B	Beam	Metal	Brown	Good	High	-0.3	Negative	N/A
43	Building Exterior	B	Screen Door	Wood	Tan	Good	High	1.0	Positive	N/A
44	Building Exterior	B	Door	Wood	Tan	Good	High	-0.1	Negative	N/A
45	Building Exterior	A	Sink	Porcelain	White	Good	High	1.0	Positive	N/A
46	Building Exterior	C	Wall	Transite	Tan	Good	High	-0.2	Negative	N/A
47	Building Exterior	C	Door	Wood	Brown	Good	High	-0.1	Negative	N/A
48	Building Exterior	C	Wall	Concrete	Brown	Good	High	0.0	Negative	N/A
49	Building Exterior	C	Beam	Metal	Brown	Good	High	-0.1	Negative	N/A
50	Building Exterior	C	Window Frame	Wood	Brown	Good	High	-0.2	Negative	N/A
51	Building Exterior	D	Wall	Stucco	Tan	Good	High	-0.2	Negative	N/A
52	Building Exterior	D	Window Sill	Wood	Brown	Good	High	-0.1	Negative	N/A
53	Building Exterior	D	Window Sill	Wood	Brown	Good	High	-0.0	Negative	N/A
54	Building Exterior	A	Eave	Metal	Brown	Good	High	-0.1	Negative	N/A
55	Building Exterior	A	Beam	Wood	Brown	Good	High	0.0	Negative	N/A

LEGEND:

HUD Definitions:

HUD level for lead paint = 1.0 mg/cm²
Positive = XRF sampling with levels above 1.2 mg/cm².
Inconclusive = XRF sampling with levels between 0.8 and 1.2 mg/cm².

CLC = Corrected Lead Concentration.

Accessibility:

High - Accessible to a minor child (60" from base).
Medium - Can be accessible to a minor child.
Low - Is not accessible to a minor child.

Condition:

Good - Surface intact with no delamination or chipping.
Fair - Some minor damage.
Poor - Widespread chipping, damage and/or delamination.

TABLE I
LEAD SURVEY SUMMARY

CLIENT: City of Los Angeles Parks & Recreation
LOCATION: Encino/Balboa Golf Course, Los Angeles, CA - BUILDING B

DATE: October 19, 2003
SHEET: 1 of 3

Sample #	Room/Area	Side	Component	Substrate	Color	Condition	Accessibility	CLC	Results	Quantity
01	Men's Restroom	A	Wall	Ceramic	Light Blue	Good	High	-0.1	Negative	N/A
02	Men's Restroom	A	Baseboard	Ceramic	Brown	Good	High	-0.1	Negative	N/A
03	Men's Restroom	A	Toilet	Porcelain	White	Good	High	-0.2	Negative	N/A
04	Men's Restroom	A	Dispenser	Metal	White	Good	High	-0.1	Negative	N/A
05	Men's Restroom	B	Wall	Ceramic	Light Blue	Good	High	-0.1	Negative	N/A
06	Men's Restroom	B	Baseboard	Ceramic	Brown	Good	High	-0.0	Negative	N/A
07	Men's Restroom	C	Wall	Ceramic	Light Blue	Good	High	-0.2	Negative	N/A
08	Men's Restroom	C	Sink	Porcelain	White	Good	High	-0.3	Negative	N/A
09	Men's Restroom	C	Urinal	Porcelain	White	Good	High	-0.1	Negative	N/A
10	Men's Restroom	C	Baseboard	Ceramic	Brown	Good	High	-0.3	Negative	N/A
11	Men's Restroom	D	Wall	Ceramic	Light Blue	Good	High	-0.1	Negative	N/A
12	Men's Restroom	C	Hand Dryer	Porcelain	White	Good	High	-0.3	Negative	N/A
13	Men's Restroom	C	Mirror Frame	Wood	White	Good	High	0.1	Negative	N/A
14	Men's Restroom	D	Door Casing	Wood	Green	Good	High	1.0	Positive	N/A
15	Men's Restroom	D	Door Jamb	Wood	Green	Good	High	4.7	Positive	N/A
16	Men's Restroom	D	Door Header	Wood	Green	Good	High	1.0	Positive	N/A
17	Men's Restroom	--	Floor	Ceramic	Red	Good	High	-0.2	Negative	N/A
18	Men's Restroom	--	Ceiling	Drywall	White	Poor	High	-0.1	Negative	N/A
19	Women's Restroom	A	Wall	Ceramic	Light Blue	Good	High	0.0	Negative	N/A
20	Women's Restroom	A	Baseboard	Ceramic	Brown	Good	High	-0.1	Negative	N/A
21	Women's Restroom	A	Partition Post	Wood	Tan	Good	High	0.1	Negative	N/A
22	Women's Restroom	A	Partition Door	Wood	Tan	Good	High	0.6	Negative	N/A
23	Women's Restroom	A	Toilet	Porcelain	White	Good	High	-0.3	Negative	N/A
24	Women's Restroom	B	Wall	Ceramic	Light Blue	Good	High	-0.1	Negative	N/A
25	Women's Restroom	B	Baseboard	Ceramic	Brown	Good	High	-0.0	Negative	N/A
26	Women's Restroom	B	Door Casing	Wood	Green	Good	High	1.4	Positive	N/A
27	Women's Restroom	B	Door Jamb	Wood	Green	Good	High	5.7	Positive	N/A
28	Women's Restroom	B	Door Header	Wood	Green	Good	High	5.2	Positive	N/A
29	Women's Restroom	C	Wall	Ceramic	Light Blue	Good	High	-0.2	Negative	N/A
30	Women's Restroom	C	Sink	Ceramic	White	Good	High	-0.6	Negative	N/A
31	Women's Restroom	C	Baseboard	Ceramic	Brown	Good	High	-0.1	Negative	N/A
32	Women's Restroom	C	Dispenser	Metal	White	Good	High	-0.0	Negative	N/A
33	Women's Restroom	C	Mirror Frame	Wood	White	Good	High	0.1	Negative	N/A
34	Women's Restroom	C	Hand Dryer	Metal	White	Good	High	-0.2	Negative	N/A
35	Women's Restroom	D	Wall	Ceramic	Light Blue	Good	High	-0.0	Negative	N/A
36	Women's Restroom	--	Floor	Ceramic	Red	Good	High	-0.3	Negative	N/A
37	Women's Restroom	--	Ceiling	Plaster	White	Poor	High	-0.1	Negative	N/A

LEGEND:

HUD Definitions:

HUD level for lead paint = 1.0 mg/cm².

Positive = XRF sampling with levels above 1.2 mg/cm².

Inconclusive = XRF sampling with levels between 0.8 and 1.2 mg/cm².

CLC = Corrected Lead Concentration.

Accessibility:

High - Accessible to a minor child (60" from base).

Medium - Can be accessible to a minor child.

Low - Is not accessible to a minor child.

Condition:

Good - Surface intact with no delamination or chipping.

Fair - Some minor damage.

Poor - Widespread chipping, damage and/or delamination.

TABLE I
LEAD SURVEY SUMMARY

CLIENT: City of Los Angeles Parks & Recreation
LOCATION: Encino/Balboa Golf Course, Los Angeles, CA - BUILDING B

DATE: October 19, 2003
SHEET: 2 of 3

Sample #	Room/Area	Side	Component	Substrate	Color	Condition	Accessibility	CLC	Results	Quantity
38	Building Exterior	B	Wall	Brick	White	Good	High	0.3	Negative	N/A
39	Building Exterior	B	Window Apron	Brick	White	Good	High	0.1	Negative	N/A
40	Building Exterior	B	Door Casing	Wood	Green	Good	High	5.3	Positive	N/A
41	Building Exterior	B	Water Fountain	Concrete	Green	Good	High	-0.4	Negative	N/A
42	Building Exterior	B	Water Fountain	Concrete	Orange	Good	High	-0.0	Negative	N/A
43	Building Exterior	B	Trim	Concrete	Green	Good	High	-0.2	Negative	N/A
44	Building Exterior	B	Door	Wood	Green	Good	High	-0.0	Negative	N/A
45	Building Exterior	B	Window Frame	Metal	Green	Good	High	4.4	Positive	N/A
46	Building Exterior	B	Window Sash	Metal	Green	Good	High	0.4	Negative	N/A
47	Building Exterior	B	Window Casing	Concrete	Green	Good	High	3.4	Positive	N/A
48	Building Exterior	B	Beam	Metal	Green	Good	High	2.4	Positive	N/A
49	Building Exterior	--	Ceiling	Stucco	White	Good	High	0.2	Negative	N/A
50	Building Exterior	B	Facia	Wood	Green	Good	High	6.2	Positive	N/A
51	Building Exterior	B	Flashing	Metal	Green	Good	High	0.1	Negative	N/A
52	Building Exterior	C	Wall	Stucco	White	Good	High	0.3	Negative	N/A
53	Building Exterior	C	Trim	Concrete	Green	Good	High	-0.3	Negative	N/A
54	Building Exterior	C	Wall	Brick	White	Good	High	0.0	Negative	N/A
55	Building Exterior	C	Door	Wood	Green	Good	High	6.4	Positive	N/A
56	Building Exterior	C	Vent	Metal	Green	Good	High	2.4	Positive	N/A
57	Building Exterior	C	Door Casing	Wood	Green	Good	High	4.9	Positive	N/A
58	Building Exterior	C	Window Frame	Metal	Green	Good	High	3.5	Positive	N/A
59	Building Exterior	C	Door Lock	Metal	Green	Good	High	-0.2	Negative	N/A
60	Building Exterior	C	Door Jamb	Wood	Green	Good	High	1.0	Positive	N/A
61	Building Exterior	C	Wall	Wood	White	Good	High	-0.3	Negative	N/A
62	Building Exterior	C	Column	Metal	Green	Good	High	5.6	Positive	N/A
63	Building Exterior	D	Window	Glass	Tan	Good	High	0.4	Negative	N/A
64	Building Exterior	D	Counter Top	Ceramic	Green	Good	High	-0.2	Negative	N/A
65	Building Exterior	D	Bar	Metal	White	Good	High	1.6	Positive	N/A
66	Building Exterior	D	Wall	Brick	White	Good	High	0.2	Negative	N/A
67	Building Exterior	D	Trim	Concrete	White	Good	High	-0.2	Negative	N/A
68	Building Exterior	D	Window Frame	Metal	White	Good	High	4.6	Positive	N/A
69	Building Exterior	C	Threshold	Ceramic	Red	Good	High	0.4	Negative	N/A
70	Building Exterior	D	Door	Wood	Green	Good	High	6.0	Positive	N/A
71	Building Exterior	D	Door Casing	Wood	Green	Good	High	6.1	Positive	N/A
72	Building Exterior	D	Door Frame	Wood	Green	Good	High	3.5	Positive	N/A
73	Building Exterior	D	Door Header	Wood	Green	Good	High	3.2	Positive	N/A
74	Building Exterior	D	Water Fountain	Concrete	Orange	Good	High	0.0	Negative	N/A

LEGEND:

HUD Definitions:
 HUD level for lead paint = 1.0 mg/cm².
 Positive = XRF sampling with levels above 1.2 mg/cm².
 Inconclusive = XRF sampling with levels between 0.8 and 1.2 mg/cm².
 CLC = Corrected Lead Concentration.

Accessibility:
 High - Accessible to a minor child (60" from base).
 Medium - Can be accessible to a minor child.
 Low - Is not accessible to a minor child.

Condition:
 Good - Surface intact with no delamination or chipping.
 Fair - Some minor damage.
 Poor - Widespread chipping, damage and/or delamination.

TABLE I
LEAD SURVEY SUMMARY

CLIENT: City of Los Angeles Parks & Recreation
LOCATION: Encino/Balboa Golf Course, Los Angeles, CA - BUILDING B

DATE: October 19, 2003
SHEET: 3 of 3

Sample #	Room/Area	Side	Component	Substrate	Color	Condition	Accessibility	CLC	Results	Quantity
75	Building Exterior	D	Panel	Metal	White	Good	High	-0.1	Negative	N/A
76	Storage Room	A	Wall	Brick	Green	Good	High	0.0	Negative	N/A
77	Storage Room	C	Door	Wood	Green	Good	High	1.0	Positive	N/A
78	Storage Room	C	Door Casing	Wood	White	Good	High	1.0	Positive	N/A
79	Storage Room	C	Trim	Ceramic	Green	Good	High	1.0	Positive	N/A
80	Storage Room	C	Trim	Ceramic	Red	Good	High	-0.1	Negative	N/A
81	Storage Room	C	Wall	Brick	Green	Good	High	-0.0	Negative	N/A
82	Storage Room	D	Window Frame	Metal	Green	Good	High	-0.1	Negative	N/A
83	Storage Room	D	Window	Glass	Green	Good	High	-0.4	Negative	N/A
84	Storage Room	D	Interior Shelves	Wood	Green	Good	High	1.6	Positive	N/A
85	Storage Room	D	Cabinet	Wood	Green	Good	High	1.0	Positive	N/A
86	Storage Room	--	Ceiling	Sand Plaster	White	Good	High	-0.3	Negative	N/A

LEGEND:

HUD Definitions:

HUD level for lead paint = 1.0 mg/cm².
Positive = XRF sampling with levels above 1.2 mg/cm².
Inconclusive = XRF sampling with levels between 0.8 and 1.2 mg/cm².

CLC = Corrected Lead Concentration.

Accessibility:

High - Accessible to a minor child (60" from base).
Medium - Can be accessible to a minor child.
Low - Is not accessible to a minor child.

Condition:

Good - Surface intact with no delamination or chipping.
Fair - Some minor damage.
Poor - Widespread chipping, damage and/or delamination.

TABLE I
LEAD SURVEY SUMMARY

CLIENT: City of Los Angeles Parks & Recreation
LOCATION: Encino/Balboa Golf Course, Los Angeles, CA - BUILDING C

DATE: October 19, 2003
SHEET: 1 of 2

Sample #	Room/Area	Side	Component	Substrate	Color	Condition	Accessibility	CLC	Results	Quantity
01	Men's Restroom	A	Wall	Ceramic	White	Good	High	9.9	Positive	N/A
02	Men's Restroom	A	Partition Post	Metal	Tan	Good	High	-0.1	Negative	N/A
03	Men's Restroom	B	Wall	Brick	Red	Good	High	-0.2	Negative	N/A
04	Men's Restroom	B	Baseboard	Ceramic	White	Good	High	9.3	Positive	N/A
05	Men's Restroom	B	Wall	Ceramic	White	Good	High	9.9	Positive	N/A
06	Men's Restroom	B	Urinal	Porcelain	White	Good	High	-0.3	Negative	N/A
07	Men's Restroom	C	Door Casing	Metal	White	Good	High	-0.2	Negative	N/A
08	Men's Restroom	C	Door Jamb	Metal	Green	Good	High	0.3	Negative	N/A
09	Men's Restroom	C	Door Header	Metal	Green	Good	High	0.2	Negative	N/A
10	Men's Restroom	C	Baseboard	Ceramic	White	Good	High	9.9	Positive	N/A
11	Men's Restroom	C	Wall	Brick	Red	Good	High	-0.3	Negative	N/A
12	Men's Restroom	D	Hand Dryer	Porcelain	White	Good	High	-0.3	Negative	N/A
13	Men's Restroom	D	Wall	Ceramic	White	Good	High	9.9	Positive	N/A
14	Men's Restroom	D	Sink	Porcelain	White	Good	High	-0.4	Negative	N/A
15	Men's Restroom	D	Partition Wall	Metal	Tan	Good	High	-0.1	Negative	N/A
16	Men's Restroom	D	Partition Door	Porcelain	White	Good	High	-0.0	Negative	N/A
17	Men's Restroom	D	Toilet	Metal	Tan	Good	High	-0.4	Negative	N/A
18	Men's Restroom	--	Floor	Ceramic	Brown	Good	High	0.4	Negative	N/A
19	Men's Restroom	--	Ceiling	Plaster	White	Good	High	-0.1	Negative	N/A
20	Women's Restroom	A	Wall	Ceramic	White	Good	High	9.9	Positive	N/A
21	Women's Restroom	A	Partition Post	Metal	Tan	Good	High	-0.1	Negative	N/A
22	Women's Restroom	B	Toilet	Porcelain	White	Good	High	-0.2	Negative	N/A
23	Women's Restroom	B	Dispenser	Metal	White	Good	High	-0.1	Negative	N/A
24	Women's Restroom	B	Partition Door	Metal	Tan	Good	High	-0.1	Negative	N/A
25	Women's Restroom	B	Partition Wall	Metal	Tan	Good	High	-0.2	Negative	N/A
26	Women's Restroom	B	Wall	Ceramic	White	Good	High	9.9	Positive	N/A
27	Women's Restroom	B	Sink	Porcelain	White	Good	High	-0.2	Negative	N/A
28	Women's Restroom	B	Hand Dryer	Porcelain	White	Good	High	7.3	Positive	N/A
29	Women's Restroom	C	Wall	Brick	Red	Good	High	-0.1	Negative	N/A
30	Women's Restroom	C	Baseboard	Ceramic	White	Good	High	9.5	Positive	N/A
31	Women's Restroom	C	Door Casing	Metal	White	Good	High	-0.1	Negative	N/A
32	Women's Restroom	C	Door Jamb	Metal	Green	Good	High	0.5	Negative	N/A
33	Women's Restroom	C	Door Header	Metal	Green	Good	High	-0.1	Negative	N/A
34	Women's Restroom	C	Door	Wood	White	Good	High	-0.0	Negative	N/A
35	Women's Restroom	D	Wall	Brick	Red	Good	High	-0.3	Negative	N/A
36	Women's Restroom	D	Baseboard	Ceramic	White	Good	High	9.9	Positive	N/A
37	Women's Restroom	D	Dispenser	Metal	White	Good	High	-0.0	Negative	N/A

LEGEND:

HUD Definitions:

HUD level for lead paint = 1.0 mg/cm².
Positive = XRF sampling with levels above 1.2 mg/cm².
Inconclusive = XRF sampling with levels between 0.8 and 1.2 mg/cm².

Accessibility:

High - Accessible to a minor child (60" from base).
Medium - Can be accessible to a minor child.
Low - Is not accessible to a minor child.

Condition:

Good - Surface intact with no delamination or chipping.
Fair - Some minor damage.
Poor - Widespread chipping, damage and/or delamination.

CLC = Corrected Lead Concentration.

TABLE I
LEAD SURVEY SUMMARY

CLIENT: City of Los Angeles Parks & Recreation
LOCATION: Encino/Balboa Golf Course, Los Angeles, CA - BUILDING C

DATE: October 19, 2003
SHEET: 2 of 2

Sample #	Room/Area	Side	Component	Substrate	Color	Condition	Accessibility	CLC	Results	Quantity
38	Women's Restroom	--	Floor	Ceramic	Brown	Good	High	-0.1	Negative	N/A
39	Women's Restroom	--	Ceiling	Plaster	White	Good	High	-0.1	Negative	N/A
40	Building Exterior	C	Door Casing	Metal	Green	Good	High	-0.1	Negative	N/A
41	Building Exterior	C	Door	Wood	Tan	Good	High	0.3	Negative	N/A
42	Building Exterior	C	Facia	Wood	Green	Good	High	0.4	Negative	N/A
43	Building Exterior	C	Flashing	Metal	Green	Good	High	0.2	Negative	N/A
44	Building Exterior	--	Ceiling	Stucco	White	Good	High	0.4	Negative	N/A

LEGEND:

HUD Definitions:

HUD level for lead paint = 1.0 mg/cm².
Positive = XRF sampling with levels above 1.2 mg/cm².
Inconclusive = XRF sampling with levels between 0.8 and 1.2 mg/cm².

CLC = Corrected Lead Concentration.

Accessibility:

High - Accessible to a minor child (60" from base).
Medium - Can be accessible to a minor child.
Low - Is not accessible to a minor child.

Condition:

Good - Surface intact with no delamination or chipping.
Fair - Some minor damage.
Poor - Widespread chipping, damage and/or delamination.

TABLE I
LEAD SURVEY SUMMARY

CLIENT: City of Los Angeles Parks & Recreation
LOCATION: Encino/Balboa Golf Course, Los Angeles, CA - BUILDING D

DATE: October 19, 2003
SHEET: 1 of 2

Sample #	Room/Area	Side	Component	Substrate	Color	Condition	Accessibility	CLC	Results	Quantity
01	Men's Restroom	A	Wall	Ceramic	White	Good	High	7.7	Positive	N/A
02	Men's Restroom	A	Urinal	Porcelain	White	Good	High	-0.2	Negative	N/A
03	Men's Restroom	A	Partition Post	Metal	Tan	Good	High	-0.1	Negative	N/A
04	Men's Restroom	A	Partition Door	Metal	Tan	Good	High	-0.2	Negative	N/A
05	Men's Restroom	A	Toilet	Porcelain	White	Good	High	-0.2	Negative	N/A
06	Men's Restroom	B	Wall	Ceramic	White	Good	High	7.9	Positive	N/A
07	Men's Restroom	B	Sink	Porcelain	White	Good	High	-0.2	Negative	N/A
08	Men's Restroom	C	Hand Dryer	Porcelain	White	Good	High	-0.1	Negative	N/A
09	Men's Restroom	C	Door Casing	Wood	White	Good	High	-0.0	Negative	N/A
10	Men's Restroom	C	Door Jamb	Wood	White	Good	High	-0.1	Negative	N/A
11	Men's Restroom	C	Door Header	Wood	White	Good	High	-0.3	Negative	N/A
12	Men's Restroom	C	Wall	Ceramic	White	Good	High	7.4	Positive	N/A
13	Men's Restroom	D	Wall	Ceramic	White	Good	High	8.1	Positive	N/A
14	Men's Restroom	--	Ceiling	Ceramic	White	Good	High	6.9	Positive	N/A
15	Men's Restroom	--	Ceiling	Drywall	White	Good	High	-0.3	Negative	N/A
16	Men's Restroom	--	Floor	Ceramic	White	Good	High	-0.5	Negative	N/A
17	Men's Locker Room	A	Wall	Drywall	White	Good	High	-0.1	Negative	N/A
18	Men's Locker Room	A	Door Casing	Wood	White	Good	High	-0.1	Negative	N/A
19	Men's Locker Room	A	Door	Wood	White	Good	High	-0.1	Negative	N/A
20	Men's Locker Room	A	Baseboard	Wood	White	Good	High	-0.5	Negative	N/A
21	Men's Locker Room	B	Wall	Vinyl	White	Good	High	-0.1	Negative	N/A
22	Men's Locker Room	B	Door Casing	Concrete	White	Good	High	-0.4	Negative	N/A
23	Men's Locker Room	B	Door	Metal	White	Good	High	-0.1	Negative	N/A
24	Men's Locker Room	B	Baseboard	Metal	White	Good	High	0.2	Negative	N/A
25	Men's Locker Room	C	Wall	Vinyl	White	Good	High	-0.4	Negative	N/A
26	Men's Locker Room	D	Wall	Drywall	White	Good	High	-0.2	Negative	N/A
27	Men's Locker Room	D	Baseboard	Vinyl	White	Good	High	-0.2	Negative	N/A
28	Men's Locker Room	--	Ceiling	Sand Plaster	White	Good	High	0.2	Negative	N/A
29	Men's Locker Room	--	Beam	Wood	White	Good	High	-0.2	Negative	N/A
30	Men's Locker Room	D	Window Frame	Wood	White	Good	High	0.2	Negative	N/A
31	Women's Restroom	A	Wall	Ceramic	White	Good	High	8.1	Positive	N/A
32	Women's Restroom	A	Toilet	Porcelain	White	Good	High	-0.3	Negative	N/A
33	Women's Restroom	A	Partition Post	Metal	Gray	Good	High	-0.0	Negative	N/A
34	Women's Restroom	B	Wall	Ceramic	White	Good	High	6.4	Positive	N/A
35	Women's Restroom	B	Toilet	Porcelain	White	Good	High	-0.2	Negative	N/A
36	Women's Restroom	B	Partition Door	Metal	Gray	Good	High	-0.0	Negative	N/A
37	Women's Restroom	C	Wall	Ceramic	White	Good	High	7.6	Positive	N/A

LEGEND:

HUD Definitions:

HUD level for lead paint = 1.0 mg/cm².

Positive = XRF sampling with levels above 1.2 mg/cm².

Inconclusive = XRF sampling with levels between 0.8 and 1.2 mg/cm².

CLC = Corrected Lead Concentration.

Accessibility:

High - Accessible to a minor child (60" from base).

Medium - Can be accessible to a minor child.

Low - Is not accessible to a minor child.

Condition:

Good - Surface intact with no delamination or chipping.

Fair - Some minor damage.

Poor - Widespread chipping, damage and/or delamination.

TABLE 1
LEAD SURVEY SUMMARY

CLIENT: City of Los Angeles Parks & Recreation
LOCATION: Encino/Balboa Golf Course, Los Angeles, CA - BUILDING D

DATE: October 19, 2003
SHEET: 2 of 2

Sample #	Room/Area	Side	Component	Substrate	Color	Condition	Accessibility	CLC	Results	Quantity
38	Women's Restroom	C	Door Casing	Wood	White	Good	High	-0.1	Negative	N/A
39	Women's Restroom	C	Door Jamb	Wood	White	Good	High	-0.2	Negative	N/A
40	Women's Restroom	C	Door Header	Wood	White	Good	High	0.0	Negative	N/A
41	Women's Restroom	C	Wall	Ceramic	White	Good	High	7.5	Positive	N/A
42	Women's Restroom	C	Hand Dryer	Porcelain	White	Good	High	-0.2	Negative	N/A
43	Women's Restroom	D	Wall	Ceramic	White	Good	High	8.0	Positive	N/A
44	Women's Restroom	D	Sink	Porcelain	White	Good	High	-0.3	Negative	N/A
45	Women's Restroom	C	Door	Wood	White	Good	High	0.0	Negative	N/A
46	Women's Locker Room	A	Wall	Drywall	White	Good	High	-0.2	Negative	N/A
47	Women's Locker Room	A	Door Casing	Wood	White	Good	High	-0.1	Negative	N/A
48	Women's Locker Room	A	Partition Wall	Wood	White	Good	High	-0.1	Negative	N/A
49	Women's Locker Room	A	Baseboard	Vinyl	White	Good	High	-0.3	Negative	N/A
50	Women's Locker Room	B	Wall	Drywall	White	Good	High	0.0	Negative	N/A
51	Women's Locker Room	B	Baseboard	Vinyl	White	Good	High	-0.2	Negative	N/A
52	Women's Locker Room	C	Wall	Drywall	White	Good	High	-0.1	Negative	N/A
53	Women's Locker Room	C	Box	Wood	White	Good	High	-0.1	Negative	N/A
54	Women's Locker Room	C	Baseboard	Vinyl	White	Good	High	-0.3	Negative	N/A
55	Women's Locker Room	D	Wall	Concrete	White	Good	High	0.1	Negative	N/A
56	Women's Locker Room	D	Window Sash	Wood	White	Good	High	0.2	Negative	N/A
57	Women's Locker Room	D	Window Frame	Metal	White	Good	High	0.2	Negative	N/A
58	Women's Locker Room	D	Baseboard	Vinyl	White	Good	High	0.0	Negative	N/A
59	Women's Locker Room	B	Door	Metal	White	Good	High	-0.2	Negative	N/A
60	Women's Locker Room	B	Door Frame	Metal	White	Good	High	0.2	Negative	N/A
61	Women's Locker Room	B	Door Header	Metal	White	Good	High	-0.1	Negative	N/A
62	Building Exterior	B	Facia	Wood	Green	Good	High	-0.1	Negative	N/A
63	Building Exterior	B	Wall	Brick	Red	Good	High	0.0	Negative	N/A
64	Building Exterior	B	Door Casing	Metal	Green	Good	High	-0.2	Negative	N/A
65	Building Exterior	B	Door	Metal	White	Good	High	-0.2	Negative	N/A
66	Building Exterior	B	Gutter	Metal	Red	Good	High	-0.2	Negative	N/A
67	Building Exterior	B	Beam	Wood	Green	Good	High	-0.0	Negative	N/A
68	Women's Locker Room	--	Beam	Wood	White	Good	High	-0.2	Negative	N/A
69	Women's Locker Room	--	Ceiling	Sand Plaster	White	Good	High	0.2	Negative	N/A

LEGEND:

HUD Definitions:

HUD level for lead paint = 1.0 mg/cm².

Positive = XRF sampling with levels above 1.2 mg/cm².

Inconclusive = XRF sampling with levels between 0.8 and 1.2 mg/cm².

CLC = Corrected Lead Concentration.

Accessibility:

High - Accessible to a minor child (60" from base).

Medium - Can be accessible to a minor child.

Low - Is not accessible to a minor child.

Condition:

Good - Surface intact with no delamination or chipping.

Fair - Some minor damage.

Poor - Widespread chipping, damage and/or delamination.

TABLE I
LEAD SURVEY SUMMARY

CLIENT: City of Los Angeles Parks & Recreation
LOCATION: Encino/Balboa Golf Course, Los Angeles, CA - BUILDING E

DATE: October 19, 2003
SHEET: 1 of 2

Sample #	Room/Area	Side	Component	Substrate	Color	Condition	Accessibility	CLC	Results	Quantity
01	Men's Restroom	A	Wall	Cement Board	Blue	Good	High	-0.7	Negative	N/A
02	Men's Restroom	A	Door	Wood	Blue	Good	High	-0.2	Negative	N/A
03	Men's Restroom	B	Wall	Concrete	Blue	Good	High	-0.3	Negative	N/A
04	Men's Restroom	B	Dispenser	Metal	White	Good	High	-0.1	Negative	N/A
05	Men's Restroom	C	Wall	Ceramic	Tan	Good	High	9.8	Positive	N/A
06	Men's Restroom	C	Wall	Plaster	Blue	Good	High	-0.3	Negative	N/A
07	Men's Restroom	C	Sink	Porcelain	White	Good	High	-0.4	Negative	N/A
08	Men's Restroom	C	Urinal	Porcelain	White	Good	High	-0.5	Negative	N/A
09	Men's Restroom	C	Partition Wall	Metal	Blue	Good	High	-0.2	Negative	N/A
10	Men's Restroom	C	Partition Post	Metal	Blue	Good	High	-0.1	Negative	N/A
11	Men's Restroom	D	Wall	Concrete	Blue	Good	High	-0.3	Negative	N/A
12	Men's Restroom	D	Partition Wall	Metal	Blue	Good	High	-0.2	Negative	N/A
13	Men's Restroom	C	Toilet	Porcelain	White	Good	High	-0.1	Negative	N/A
14	Men's Restroom	--	Ceiling	Metal	Blue	Good	High	-0.2	Negative	N/A
15	Women's Restroom	A	Wall	Plaster	Pink	Good	High	-0.3	Negative	N/A
16	Women's Restroom	A	Partition Wall	Metal	Pink	Good	High	-0.2	Negative	N/A
17	Women's Restroom	A	Partition Door	Metal	Pink	Good	High	-0.2	Negative	N/A
18	Women's Restroom	A	Toilet	Porcelain	White	Good	High	-0.4	Negative	N/A
19	Women's Restroom	A	Sink	Porcelain	White	Good	High	-0.7	Negative	N/A
20	Women's Restroom	A	Dispenser	Metal	White	Good	High	-0.2	Negative	N/A
21	Women's Restroom	A	Wall	Ceramic	Yellow	Good	High	9.5	Positive	N/A
22	Women's Restroom	B	Wall	Concrete	Pink	Good	High	-0.2	Negative	N/A
23	Women's Restroom	C	Wall	Cement Board	Pink	Good	High	-0.6	Negative	N/A
24	Women's Restroom	C	Door	Wood	Brown	Good	High	-0.2	Negative	N/A
25	Women's Restroom	D	Wall	Concrete	Pink	Good	High	-0.3	Negative	N/A
26	Women's Restroom	D	Partition Wall	Metal	Pink	Good	High	-0.2	Negative	N/A
27	Women's Restroom	--	Ceiling	Metal	Pink	Good	High	-0.2	Negative	N/A
28	Building Exterior	A	Wall	Cinder Block	Tan	Good	High	-0.2	Negative	N/A
29	Building Exterior	A	Door	Wood	Tan	Good	High	-0.2	Negative	N/A
30	Building Exterior	A	Wall	Cement Board	Tan	Good	High	-0.4	Negative	N/A
31	Building Exterior	A	Partition	Metal	Tan	Good	High	-0.2	Negative	N/A
32	Building Exterior	A	Brace	Metal	Brown	Good	High	-0.2	Negative	N/A
33	Building Exterior	A	Door	Wood	Brown	Good	High	-0.1	Negative	N/A
34	Building Exterior	A	Door Frame	Metal	Brown	Good	High	-0.2	Negative	N/A
35	Building Exterior	A	Beam	Metal	Brown	Good	High	0.2	Negative	N/A
36	Building Exterior	A	Eave	Metal	Brown	Good	High	-0.1	Negative	N/A
37	Building Exterior	A	Facia	Metal	Brown	Good	High	-0.2	Negative	N/A

LEGEND:

HUD Definitions:

HUD level for lead paint = 1.0 mg/cm².

Positive = XRF sampling with levels above 1.2 mg/cm².

Inconclusive = XRF sampling with levels between 0.8 and 1.2 mg/cm².

CLC = Corrected Lead Concentration.

Accessibility:

High - Accessible to a minor child (60" from base).

Medium - Can be accessible to a minor child.

Low - Is not accessible to a minor child.

Condition:

Good - Surface intact with no delamination or chipping.

Fair - Some minor damage.

Poor - Widespread chipping, damage and/or delamination.

TABLE I
LEAD SURVEY SUMMARY

CLIENT: City of Los Angeles Parks & Recreation
LOCATION: Encino/Balboa Golf Course, Los Angeles, CA - BUILDING E

DATE: October 19, 2003
SHEET: 2 of 2

Sample #	Room/Area	Side	Component	Substrate	Color	Condition	Accessibility	CLC	Results	Quantity
38	Building Exterior	A	Brace	Wood	Brown	Good	High	-0.3	Negative	N/A
39	Building Exterior	B	Wall	Cement Board	Tan	Good	High	-0.4	Negative	N/A
40	Building Exterior	B	Brace	Wood	Tan	Good	High	-0.2	Negative	N/A
41	Building Exterior	B	1" Conduit	Metal	Tan	Good	High	-0.1	Negative	N/A
42	Building Exterior	B	Facia	Metal	Brown	Good	High	-0.2	Negative	N/A
43	Building Exterior	B	Brace	Metal	Brown	Good	High	0.1	Negative	N/A
44	Building Exterior	B	Main Door	Wood	Tan	Good	High	2.7	Positive	N/A
45	Building Exterior	B	Sink	Porcelain	White	Good	High	0.6	Negative	N/A
46	Building Exterior	B	Wall	Plaster	Tan	Good	High	-0.2	Negative	N/A
47	Building Exterior	B	Shelf	Wood	Tan	Good	High	-0.1	Negative	N/A
48	Building Exterior	B	Closet Door	Wood	Tan	Good	High	-0.1	Negative	N/A
49	Building Exterior	B	Fence	Metal	Brown	Good	High	-0.0	Negative	N/A
50	Building Exterior	B	Post	Wood	Brown	Good	High	-0.0	Negative	N/A
51	Building Exterior	C	Wall	Cement Board	Tan	Good	High	-0.5	Negative	N/A
52	Building Exterior	C	Partition Wall	Metal	Tan	Good	High	-0.1	Negative	N/A
53	Building Exterior	C	Brace	Metal	Brown	Good	High	-0.2	Negative	N/A
54	Building Exterior	C	Door	Wood	Brown	Good	High	-0.1	Negative	N/A
55	Building Exterior	C	Beam	Metal	Brown	Good	High	-0.1	Negative	N/A
56	Building Exterior	C	Eave	Metal	Brown	Good	High	-0.2	Negative	N/A
57	Building Exterior	C	Door	Wood	Brown	Good	High	-0.2	Negative	N/A
58	Building Exterior	C	Window Apron	Wood	Brown	Good	High	-0.1	Negative	N/A
59	Building Exterior	C	Wall	Cinder Block	Tan	Good	High	-0.3	Negative	N/A
60	Building Exterior	C	Wall	Stucco	Tan	Good	High	0.0	Negative	N/A
61	Building Exterior	C	Window Frame	Wood	Brown	Good	High	-0.2	Negative	N/A
62	Building Exterior	D	Wall	Stucco	Tan	Good	High	0.3	Negative	N/A
63	Building Exterior	D	Window Frame	Wood	Brown	Good	High	-0.1	Negative	N/A
64	Building Exterior	D	Brace	Metal	Brown	Good	High	-0.0	Negative	N/A
65	Building Exterior	D	Beam	Metal	Brown	Good	High	0.2	Negative	N/A

LEGEND:

HUD Definitions:

HUD level for lead paint = 1.0 mg/cm².

Positive = XRF sampling with levels above 1.2 mg/cm².

Inconclusive = XRF sampling with levels between 0.8 and 1.2 mg/cm².

CLC = Corrected Lead Concentration.

Accessibility:

High - Accessible to a minor child (60" from base).

Medium - Can be accessible to a minor child.

Low - Is not accessible to a minor child.

Condition:

Good - Surface intact with no delamination or chipping.

Fair - Some minor damage.

Poor - Widespread chipping, damage and/or delamination.

TABLE I
LEAD SURVEY SUMMARY

CLIENT: City of Los Angeles Parks & Recreation
LOCATION: Encino/Balboa Golf Course, Los Angeles, CA - BUILDING F

DATE: October 19, 2003
SHEET: 1 of 2

Sample #	Room/Area	Side	Component	Substrate	Color	Condition	Accessibility	CLC	Results	Quantity
01	Women's Restroom	B	Wall	Plaster	White	Good	High	-0.1	Negative	N/A
02	Women's Restroom	B	Wall	Ceramic	Tan	Good	High	>9.9	Positive	N/A
03	Women's Restroom	B	Sink	Porcelain	White	Good	High	-0.4	Negative	N/A
04	Women's Restroom	B	Toilet	Porcelain	White	Good	High	0.3	Negative	N/A
05	Women's Restroom	B	Partition	Metal	Tan	Good	High	-0.1	Negative	N/A
06	Women's Restroom	B	Partition Door	Metal	Tan	Good	High	-0.1	Negative	N/A
07	Women's Restroom	A	Wall	Cinder Block	Light Brown	Good	High	-0.1	Negative	N/A
08	Women's Restroom	C	Wall	Cinder Block	Light Brown	Good	High	-0.1	Negative	N/A
09	Women's Restroom	D	Wall	Cinder Block	Light Brown	Good	High	-0.1	Negative	N/A
10	Women's Restroom	D	Hand Dryer	Porcelain	White	Good	High	>9.9	Positive	N/A
11	Women's Restroom	--	Ceiling	Plaster	White	Good	High	-0.1	Negative	N/A
12	Women's Restroom	D	Beam	Wood	White	Good	High	0.2	Negative	N/A
13	Women's Restroom	D	Beam Support	Metal	White	Good	High	0.3	Negative	N/A
14	Men's Restroom	A	Wall	Cinder Block	Light Brown	Good	High	0.2	Negative	N/A
15	Men's Restroom	B	Wall	Cinder Block	Light Brown	Good	High	0.2	Negative	N/A
16	Men's Restroom	B	Beam	Wood	White	Good	High	0.1	Negative	N/A
17	Men's Restroom	B	Beam Support	Metal	White	Good	High	0.4	Negative	N/A
18	Men's Restroom	B	Hand Dryer	Porcelain	White	Good	High	>9.9	Positive	N/A
19	Men's Restroom	C	Wall	Cinder Block	Light Brown	Good	High	-0.1	Negative	N/A
20	Men's Restroom	D	Wall	Plaster	White	Good	High	-0.1	Negative	N/A
21	Men's Restroom	D	Wall	Ceramic	Tan	Good	High	>9.9	Positive	N/A
22	Men's Restroom	D	Urinal	Porcelain	White	Good	High	-0.1	Negative	N/A
23	Men's Restroom	D	Sink	Porcelain	White	Good	High	0.0	Negative	N/A
24	Men's Restroom	D	Toilet	Porcelain	White	Good	High	-0.7	Negative	N/A
25	Men's Restroom	D	Partition	Metal	Tan	Good	High	-0.1	Negative	N/A
26	Men's Restroom	--	Ceiling	Plaster	White	Good	High	-0.1	Negative	N/A
27	Building Exterior	A	Wall	Cinder Block	Light Brown	Good	High	-0.1	Negative	N/A
28	Building Exterior	A	Beam	Wood	White	Good	High	0.3	Negative	N/A
29	Building Exterior	A	Facia	Wood	Green	Good	High	-0.1	Negative	N/A
30	Building Exterior	A	Trim	Metal	Green	Good	High	-0.1	Negative	N/A
31	Building Exterior	A	Deck	Plaster	White	Good	High	-0.1	Negative	N/A
32	Building Exterior	B	Wall	Cinder Block	Light Brown	Good	High	-0.1	Negative	N/A
33	Building Exterior	B	Door	Metal	Green	Good	High	0.0	Negative	N/A
34	Building Exterior	B	Door Jamb	Wood	Green	Good	High	-0.1	Negative	N/A
35	Building Exterior	B	Door Header	Wood	Green	Good	High	0.3	Negative	N/A
36	Building Exterior	B	Beam	Wood	White	Good	High	0.4	Negative	N/A
37	Building Exterior	B	Beam Brace	Metal	White	Good	High	0.2	Negative	N/A

LEGEND:

HUD Definitions:

HUD level for lead paint = 1.0 mg/cm².
Positive = XRF sampling with levels above 1.2 mg/cm².
Inconclusive = XRF sampling with levels between 0.8 and 1.2 mg/cm².

CLC = Corrected Lead Concentration.

Accessibility:

High - Accessible to a minor child (60" from base).
Medium - Can be accessible to a minor child.
Low - Is not accessible to a minor child.

Condition:

Good - Surface intact with no delamination or chipping.
Fair - Some minor damage.
Poor - Widespread chipping, damage and/or delamination.

TABLE I
LEAD SURVEY SUMMARY

CLIENT: City of Los Angeles Parks & Recreation
LOCATION: Encino/Balboa Golf Course, Los Angeles, CA - BUILDING F

DATE: October 19, 2003
SHEET: 2 of 2

Sample #	Room/Area	Side	Component	Substrate	Color	Condition	Accessibility	CLC	Results	Quantity
38	Building Exterior	B	Facia	Wood	Green	Good	High	-0.1	Negative	N/A
39	Building Exterior	B	Trim	Metal	Green	Good	High	-0.0	Negative	N/A
40	Building Exterior	C	Wall	Cinder Block	Light Brown	Good	High	-0.1	Negative	N/A
41	Building Exterior	C	Beam	Wood	White	Good	High	0.4	Negative	N/A
42	Building Exterior	C	Beam Brace	Metal	White	Good	High	0.1	Negative	N/A
43	Building Exterior	C	Facia	Wood	Green	Good	High	-0.1	Negative	N/A
44	Building Exterior	C	Trim	Metal	Green	Good	High	-0.0	Negative	N/A
45	Building Exterior	C	Door	Wood	Green	Good	High	-0.0	Negative	N/A
46	Building Exterior	C	Door Frame	Metal	Green	Good	High	-0.1	Negative	N/A
47	Building Exterior	C	Deck	Plaster	White	Good	High	-0.1	Negative	N/A
48	Building Exterior	D	Wall	Cinder Block	Light Brown	Good	High	-0.1	Negative	N/A
49	Building Exterior	D	Door	Metal	Green	Good	High	0.0	Negative	N/A
50	Building Exterior	D	Door Jamb	Wood	Green	Good	High	-0.1	Negative	N/A
51	Building Exterior	D	Beam	Wood	White	Good	High	0.3	Negative	N/A
52	Building Exterior	D	Beam Brace	Metal	White	Good	High	0.1	Negative	N/A
53	Building Exterior	D	Deck	Plaster	White	Good	High	-0.1	Negative	N/A
54	Building Exterior	D	Facia	Wood	Green	Good	High	-0.1	Negative	N/A
55	Building Exterior	D	Trim	Metal	Green	Good	High	-0.1	Negative	N/A

LEGEND:

HUD Definitions:

HUD level for lead paint = 1.0 mg/cm².
Positive = XRF sampling with levels above 1.2 mg/cm².
Inconclusive = XRF sampling with levels between 0.8 and 1.2 mg/cm².

CLC = Corrected Lead Concentration.

Accessibility:

High - Accessible to a minor child (60" from base).
Medium - Can be accessible to a minor child.
Low - Is not accessible to a minor child.

Condition:

Good - Surface intact with no delamination or chipping.
Fair - Some minor damage.
Poor - Widespread chipping, damage and/or delamination.

Encino/Balboa Golf Course
Building A

C

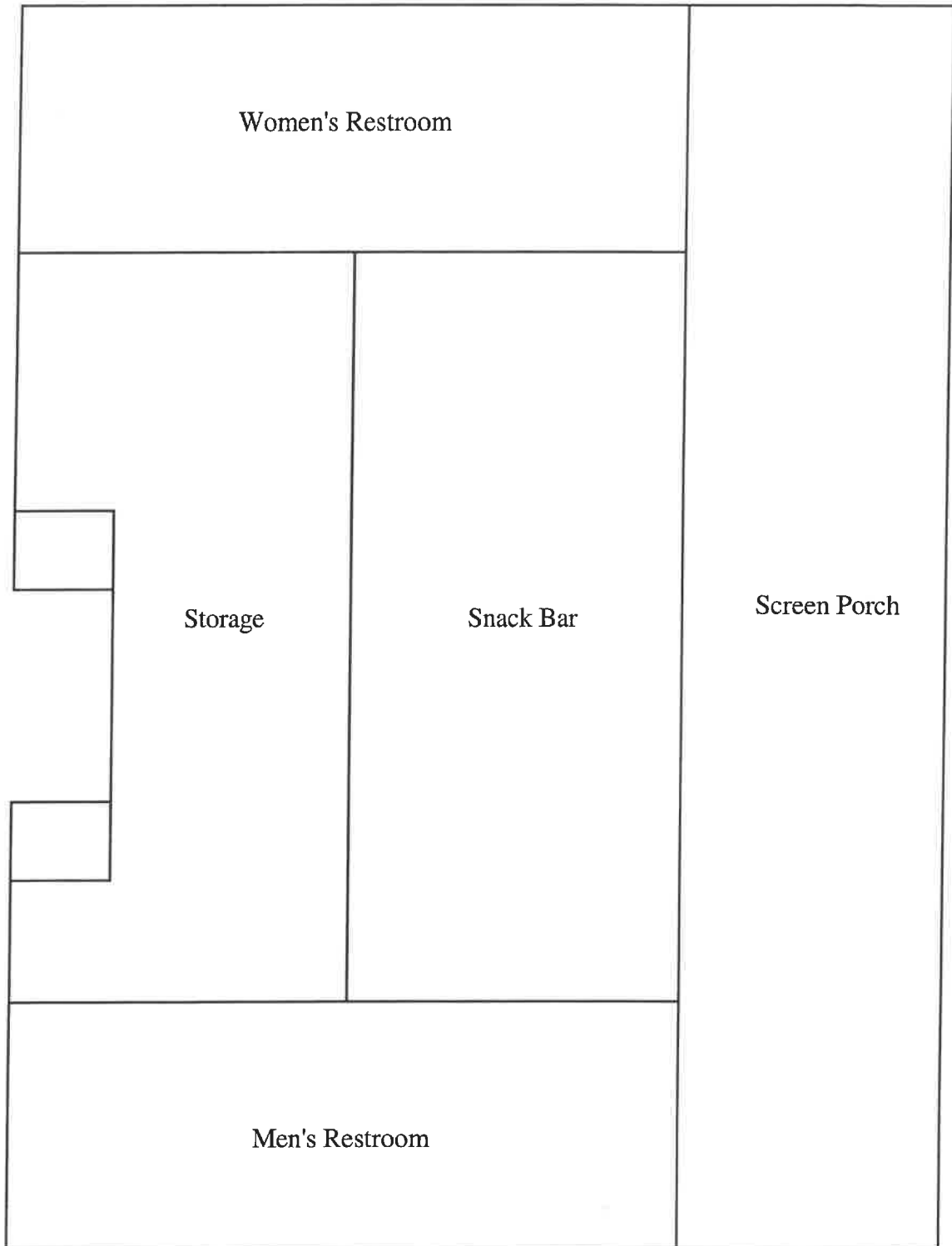

B

D

A

NOT TO SCALE

Encino/Balboa Golf Course
Building B

A

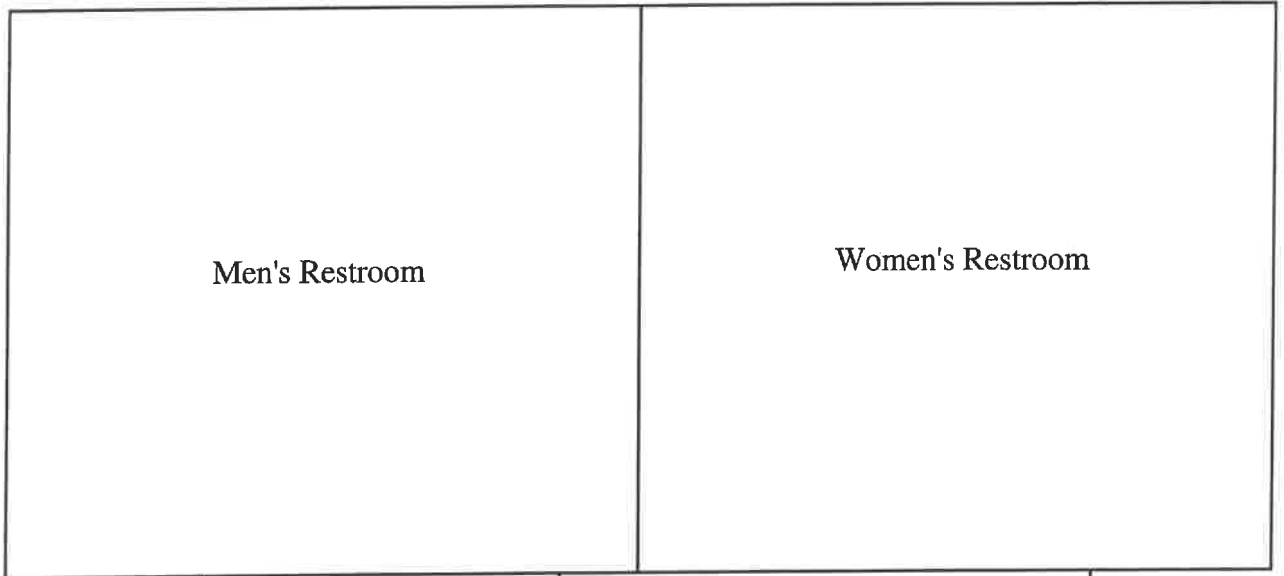

D

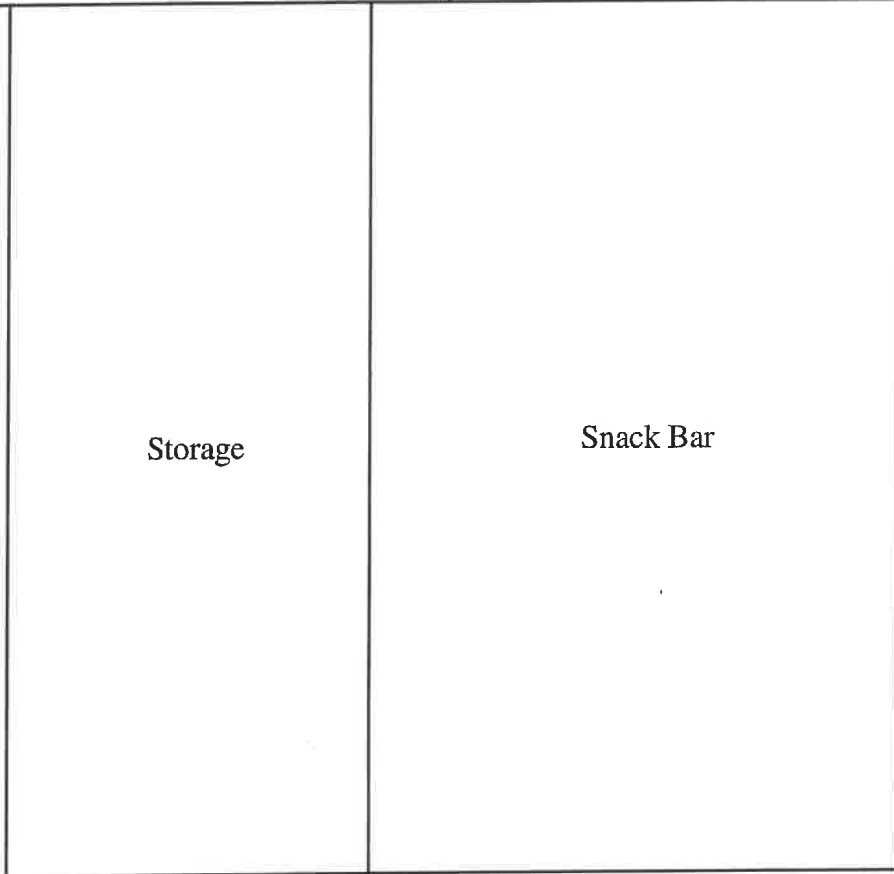

B

C

NOT TO SCALE

Encino/Balboa Golf Course
Building C

A

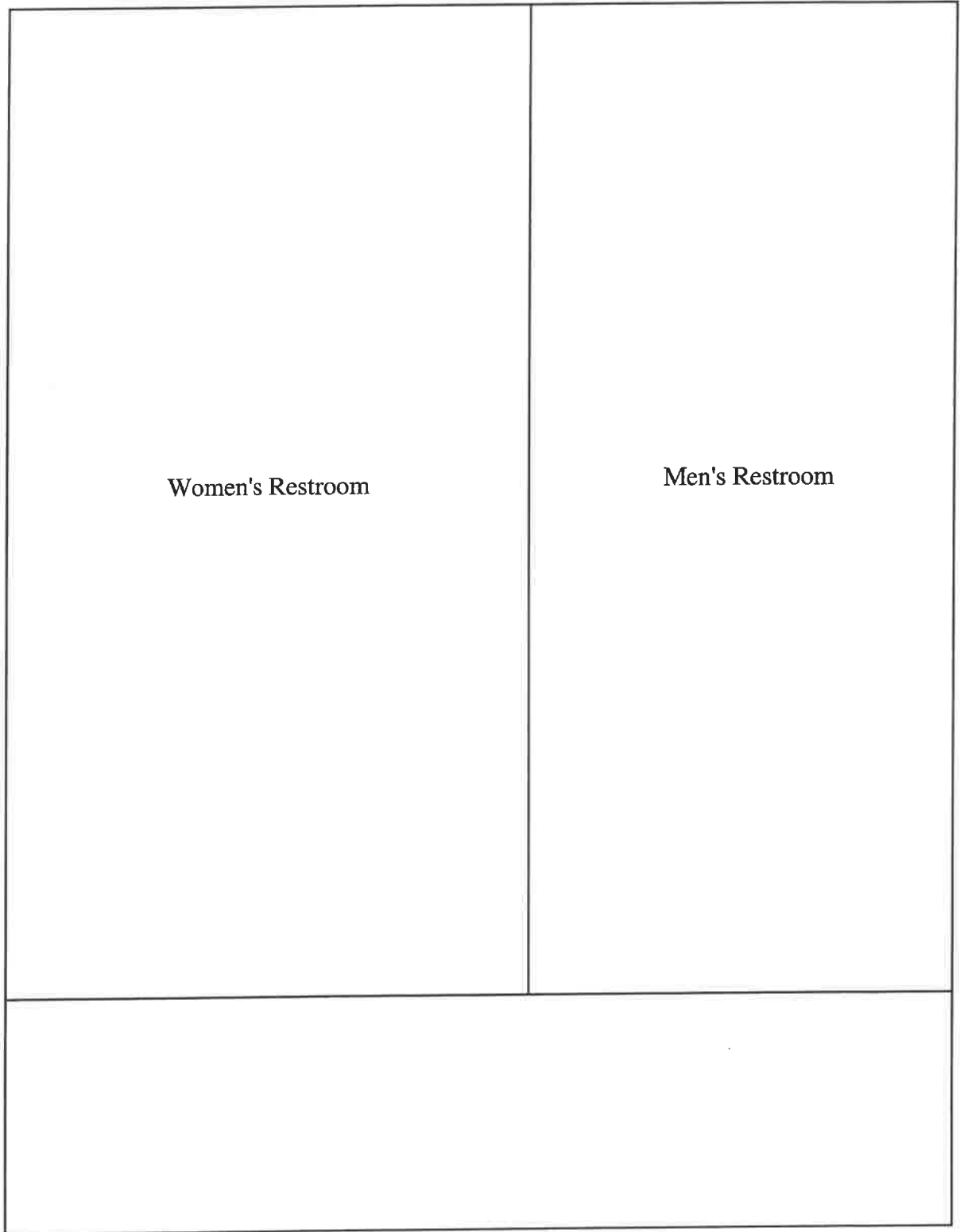

Women's Restroom

Men's Restroom

D

B

C

NOT TO SCALE

Encino/Balboa Golf Course
Building D

C

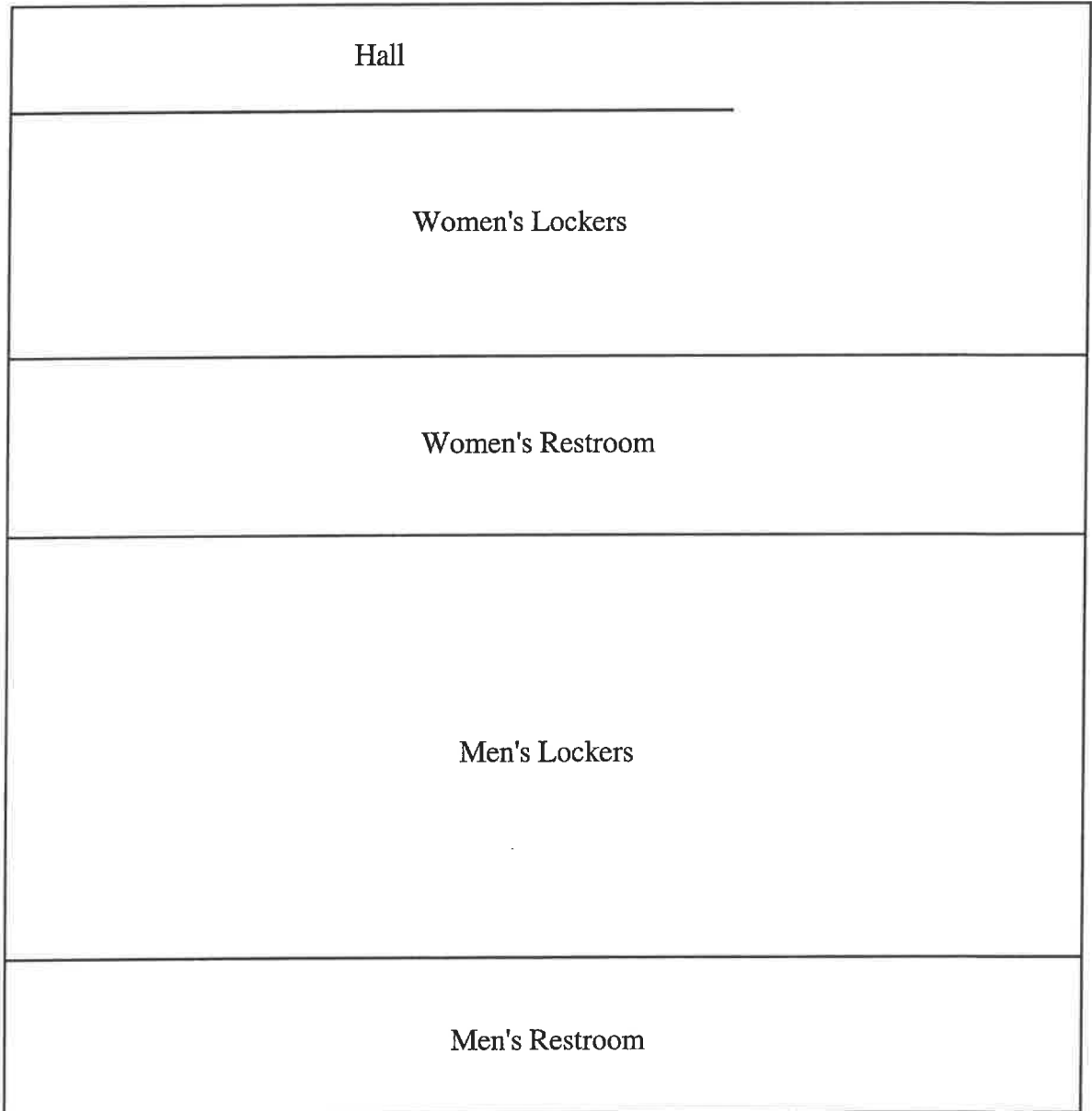

B

D

A

NOT TO SCALE

Encino/Balboa Golf Course
Building E

A

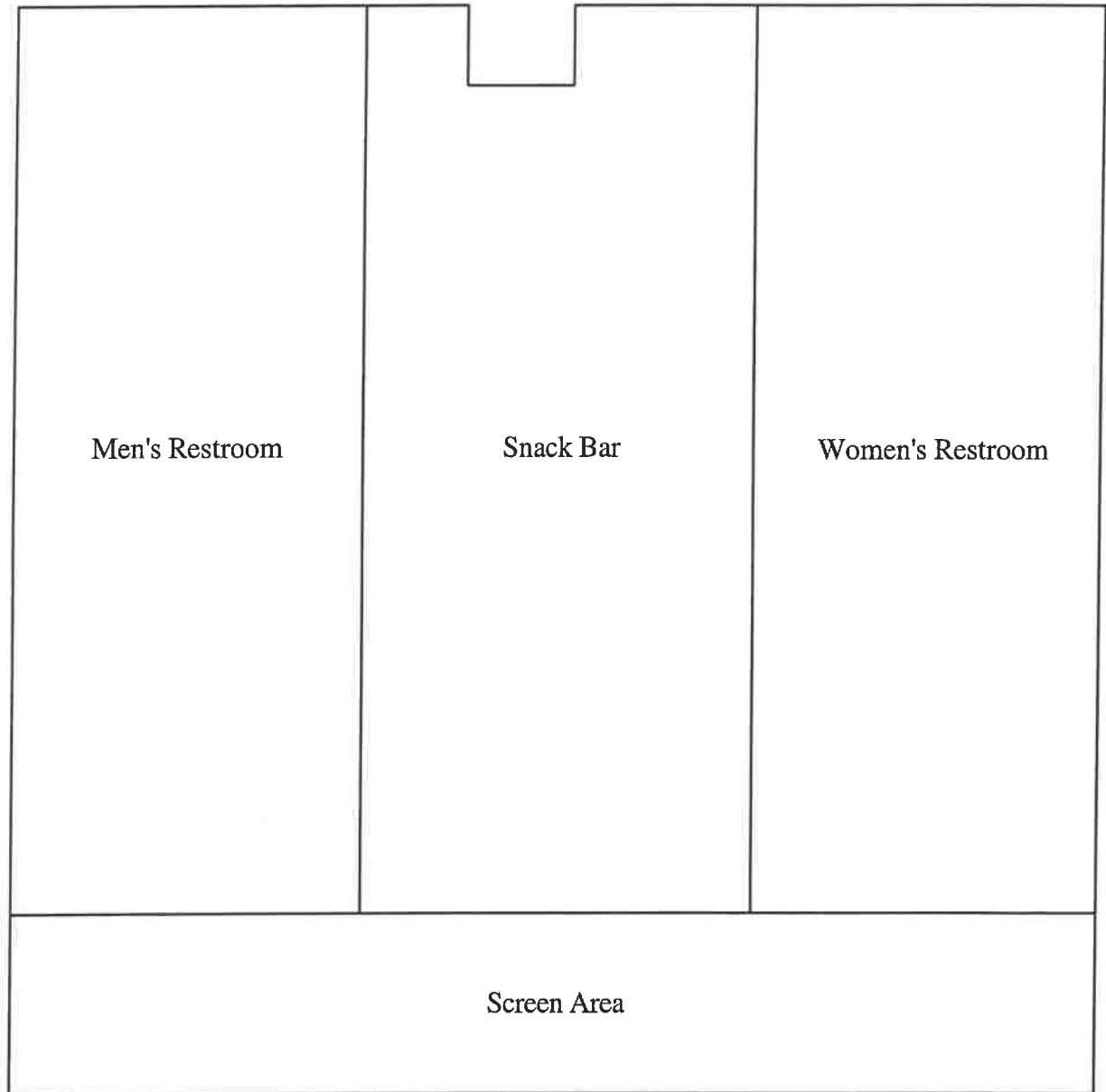

D

B

Screen Area

C

NOT TO SCALE

Encino/Balboa Golf Course
Building F

A

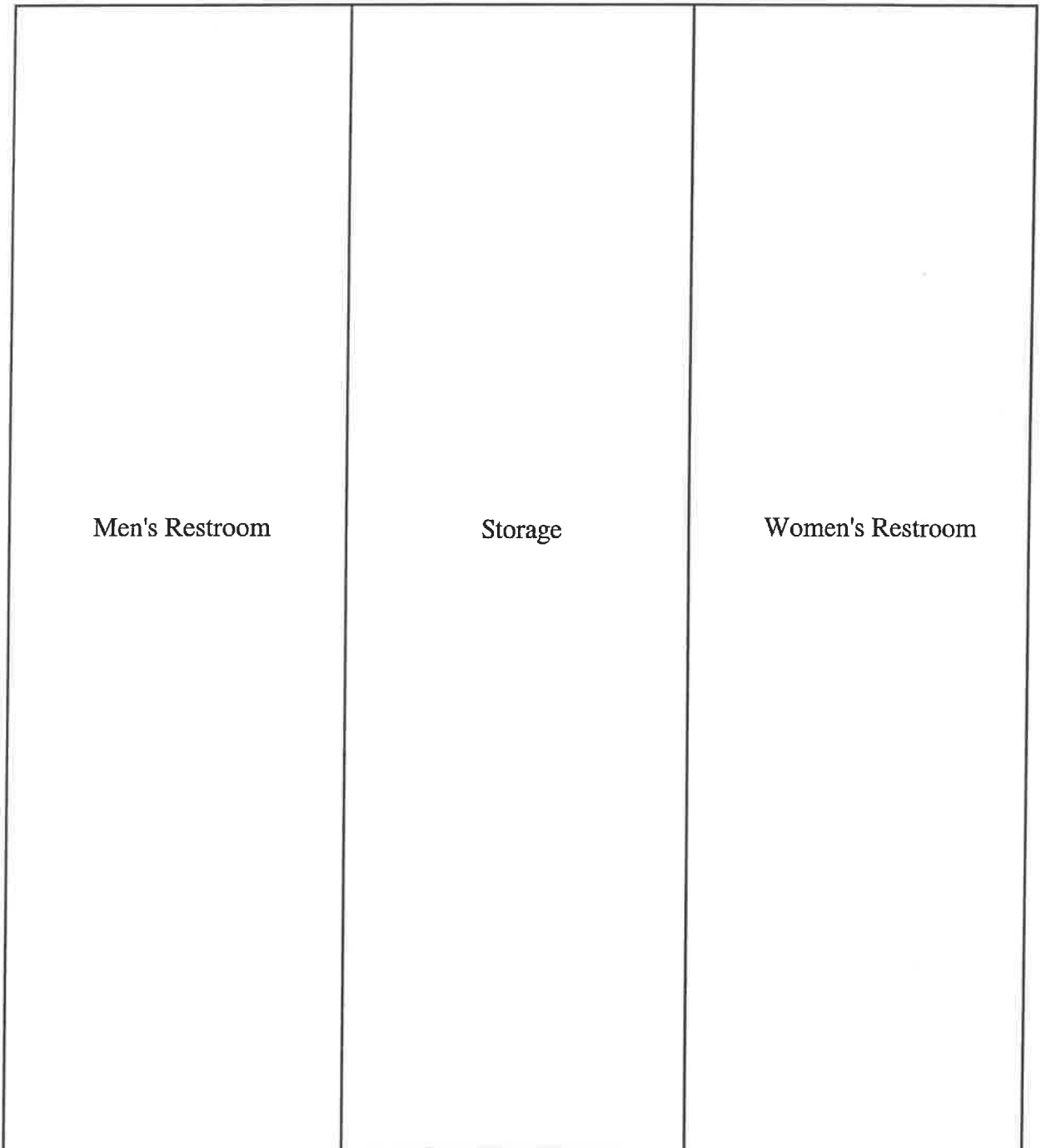

D

B

C

NOT TO SCALE



**SCIENTIFIC LABORATORIES
OF CALIFORNIA, INC.**

24416 SOUTH MAIN STREET • SUITE 308
CARSON, CA 90745
TEL: (310) 834-4868 • FAX: (310) 834-4772

September 29, 2003

National Econ Corporation
Attn: Danny De La Rosa
730 El Camino Real
Tustin, CA 92780

RE: National Econ Corporation
Job Number 903091500
P.O. # 107311-A
107311-A; LA Recs & Parks-Encino/Balboa; 16821Burbank Blvd., Building A

Dear Danny De La Rosa:

Enclosed are the results for PLM asbestos analysis of the following National Econ Corporation samples received at SCILAB on Friday, September 26, 2003, for a 48 hour turnaround:

EB-A-01, EB-A-02, EB-A-03, EB-A-04, EB-A-05, EB-A-06, EB-A-07, EB-A-08, EB-A-09, EB-A-10, EB-A-11, EB-A-12, EB-A-13, EB-A-14

The 14 samples contained in Ziplock Bags were shipped to SciLab via Hand delivery. These samples were prepared and analyzed according to the EPA Interim Method (EPA 600/M4-82-020 per 40 CFR 763, subpt F, App. A). The required analytical information, analysis results, analyst signature and laboratory identification is contained in the Analyst's Report.

This report relates ONLY to the sample analysis expressed as percent asbestos. SciLab assumes no responsibility for customer supplied data such as "sample type", "location", or "area sampled". This report must not be used to claim product endorsement by SciLab, NVLAP or any agency of the U. S. Government. The National Institute of Standards and Technology Accreditation requirements, mandates that this report must not be reproduced, except in full without the written approval of the laboratory. This report may contain specific data not covered by NVLAP or ELAP accreditations respectively, if so identified in relevant footnotes.

SciLab appreciates this opportunity to serve your organization. Please contact us for any further assistance or with any questions.

Sincerely,

Mary S. De Leon
Customer Service



**SCIENTIFIC LABORATORIES
OF CALIFORNIA, INC.**

24416 SOUTH MAIN STREET • SUITE 308
CARSON, CA 90745
TEL: (310) 834-4868 • FAX: (310) 834-4772

PLM Bulk Asbestos Report

National Econ Corporation
Attn: Danny De La Rosa
730 El Camino Real
Tustin, CA 92780

Date Received 09/26/2003 **SciLab Job No.** 903091500
Date Examined 09/29/2003 **P.O. #** 107311-A
Page 1 of 4
RE: 107311-A; LA Recs & Parks-Encino/Balboa;
16821Burbank Blvd., Building A

Client No. / HGA	Lab No.	Asbestos Present	Total % Asbestos
EB-A-01	903091500-01	No	NAD
Location: Cement Board Panels, Balboa Snack Bar, Men's			
Description: Light Grey, Heterogeneous, Cementitious, Bulk Material			
Asbestos Types:			
Other Material: Non-fibrous 100. %			
EB-A-02	903091500-02	No	NAD
Location: Cement Board Panels, Balboa Snack Bar, Women's			
Description: Light Grey, Heterogeneous, Cementitious, Bulk Material			
Asbestos Types:			
Other Material: Non-fibrous 100. %			
EB-A-03	903091500-03	No	NAD
Location: Stucco, Balboa Snack Bar, Exterior A			
Description: Light Grey, Heterogeneous, Cementitious, Bulk Material			
Asbestos Types:			
Other Material: Non-fibrous 100. %			
EB-A-04	903091500-04	Yes	20 %
Location: Stucco, Balboa Snack Bar, C Side			
Description: Grey, Heterogeneous, Cementitious, Bulk Material			
Asbestos Types: Chrysotile 20. %			
Other Material: Non-fibrous 80. %			
EB-A-05	903091500-05	Yes	20 %
Location: Stucco, Balboa Snack Bar, D Side			
Description: Grey, Heterogeneous, Bulk Material			
Asbestos Types: Chrysotile 20. %			
Other Material: Non-fibrous 80. %			



**SCIENTIFIC LABORATORIES
OF CALIFORNIA, INC.**

24416 SOUTH MAIN STREET • SUITE 308
CARSON, CA 90745
TEL: (310) 834-4868 • FAX: (310) 834-4772

PLM Bulk Asbestos Report

National Econ Corporation
Attn: Danny De La Rosa
730 El Camino Real
Tustin, CA 92780

Date Received 09/26/2003 SciLab Job No. 903091500
Date Examined 09/29/2003 P.O. # 107311-A
Page 2 of 4
RE: 107311-A; LA Recs & Parks-Encino/Balboa;
16821 Burbank Blvd., Building A

Client No. / HGA	Lab No.	Asbestos Present	Total % Asbestos
EB-A-06	903091500-06	No	NAD
Location: Plaster Wall, Balboa Snack Bar, Men's RR			
Description: White/Grey, Heterogeneous, Cementitious, Bulk Material			
Asbestos Types:			
Other Material: Non-fibrous 100. %			
EB-A-07	903091500-07	No	NAD
Location: Plaster Wall, Balboa Snack Bar, Men's RR			
Description: White/Grey, Heterogeneous, Cementitious, Bulk Material			
Asbestos Types:			
Other Material: Non-fibrous 100. %			
EB-A-08	903091500-08	No	NAD
Location: Plaster Wall, Balboa Snack Bar, Women's RR			
Description: White/Grey, Heterogeneous, Cementitious, Bulk Material			
Asbestos Types:			
Other Material: Non-fibrous 100. %			
EB-A-09	903091500-09	No	NAD
Location: Capsheet-Roof, Balboa Snack Bar-Roof			
Description: Black/Brown, Heterogeneous, Bulk Material			
Asbestos Types:			
Other Material: Cellulose 50. %, Fibrous glass 5. %, Non-fibrous 45. %			
EB-A-10	903091500-10	No	NAD
Location: Capsheet-Roof, Balboa Snack Bar-Roof			
Description: Black/Tan, Heterogeneous, Bulk Material			
Asbestos Types:			
Other Material: Cellulose 30. %, Fibrous glass 5. %, Non-fibrous 65. %			



**SCIENTIFIC LABORATORIES
OF CALIFORNIA, INC.**

24416 SOUTH MAIN STREET • SUITE 308
CARSON, CA 90745
TEL: (310) 834-4868 • FAX: (310) 834-4772

PLM Bulk Asbestos Report

National Econ Corporation
Attn: Danny De La Rosa
730 El Camino Real
Tustin, CA 92780

Date Received 09/26/2003 SciLab Job No. 903091500

Date Examined 09/29/2003 P.O. # 107311-A

Page 3 of 4

RE: 107311-A; LA Recs & Parks-Encino/Balboa;
16821Burbank Blvd., Building A

Client No. / HGA	Lab No.	Asbestos Present	Total % Asbestos
EB-A-11	903091500-11	No	NAD
Location: Capsheet-Roof, Balboa Snack Bar-Roof			
Description: Black/Brown, Heterogeneous, Bulk Material			
Asbestos Types:			
Other Material: Cellulose 25. %, Fibrous glass 5. %, Non-fibrous 70. %			
EB-A-12	903091500-12	Yes	7 %
Location: Roof Mastic, Balboa Snack Bar-Roof			
Description: Black, Heterogeneous, Bulk Material			
Asbestos Types: Chrysotile 7. %			
Other Material: Non-fibrous 93. %			
EB-A-13	903091500-13	No	NAD
Location: Roof Mastic, Balboa Snack Bar-Roof			
Description: Grey/Black, Heterogeneous, Bulk Material			
Asbestos Types:			
Other Material: Cellulose 15. %, Non-fibrous 85. %			
EB-A-14	903091500-14	Yes	7 %
Location: Roof Mastic, Balboa Snack Bar-Roof			
Description: Grey/Black, Heterogeneous, Bulk Material			
Asbestos Types: Chrysotile 7. %			
Other Material: Non-fibrous 93. %			



**SCIENTIFIC LABORATORIES
OF CALIFORNIA, INC.**

24416 SOUTH MAIN STREET • SUITE 308
CARSON, CA 90745
TEL: (310) 834-4868 • FAX: (310) 834-4772

PLM Bulk Asbestos Report

National Econ Corporation
Attn: Danny De La Rosa
730 El Camino Real
Tustin, CA 92780

Date Received 09/26/2003 SciLab Job No. 903091500
Date Examined 09/29/2003 P.O. # 107311-A
Page 4 of 4
RE: 107311-A; LA Recs & Parks-Encino/Balboa;
16821 Burbank Blvd., Building A

Reporting Notes:

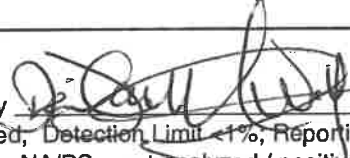
Analyzed by: David W. Falbovsky ; Date Analyzed: 9.29.03
*NAD/NSD = no asbestos detected, Detection Limit <1%; Reporting Limits: CVES = 1%, 400 Pt Ct = 0.25%, 1000 Pt Ct = 0.1%; NA = not analyzed; NA/PS = not analyzed / positive stop; PLM Bulk Asbestos Analysis by EPA 600/M4-82-020 per 40 CFR 763 (NVLAP Lab #200346-0, CA ELAP lab #2322); Note: PLM is not consistently reliable in detecting asbestos in floor coverings and similar non-friable organically bound materials. TEM is currently the only method that can be used to determine if this material can be considered or treated as non-asbestos-containing in New York State (also see EPA Advisory for floor tile, FR 59, 146, 38970, 8/1/94). National Institute of Standards and Technology Accreditation requirements mandate that this report must not be reproduced except in full without the approval of the laboratory. This PLM report relates ONLY to the items tested.

Reviewed By: 



SCILAB

**SCIENTIFIC LABORATORIES
OF CALIFORNIA, INC.**

24416 SOUTH MAIN STREET • SUITE 308
CARSON, CA 90745
TEL: (310) 834-4868 • FAX: (310) 834-4772

September 29, 2003

National Econ Corporation
Attn: Danny De La Rosa
730 El Camino Real
Tustin, CA 92780

RE: National Econ Corporation
Job Number 903091499
P.O. # 107311-B
107311-B; LA Recs & Parks-Encino/Balboa; 16821 Burbank Blvd., Building B

Dear Danny De La Rosa:

Enclosed are the results for PLM asbestos analysis of the following National Econ Corporation samples received at SCILAB on Friday, September 26, 2003, for a 48 hour turnaround:

EB-A-01, EB-A-02, EB-A-03, EB-A-04, EB-A-05, EB-A-06, EB-A-07, EB-A-08, EB-A-09

The 9 samples contained in Ziplock Bags were shipped to SciLab via Hand delivery. These samples were prepared and analyzed according to the EPA Interim Method (EPA 600/M4-82-020 per 40 CFR 763, subpt F, App. A). The required analytical information, analysis results, analyst signature and laboratory identification is contained in the Analyst's Report.

This report relates ONLY to the sample analysis expressed as percent asbestos. SciLab assumes no responsibility for customer supplied data such as "sample type", "location", or "area sampled". This report must not be used to claim product endorsement by SciLab, NVLAP or any agency of the U. S. Government. The National Institute of Standards and Technology Accreditation requirements, mandates that this report must not be reproduced, except in full without the written approval of the laboratory. This report may contain specific data not covered by NVLAP or ELAP accreditations respectively, if so identified in relevant footnotes.

SciLab appreciates this opportunity to serve your organization. Please contact us for any further assistance or with any questions.

Sincerely,



Mary S. De Leon
Customer Service



**SCIENTIFIC LABORATORIES
OF CALIFORNIA, INC.**

24416 SOUTH MAIN STREET • SUITE 308
CARSON, CA 90745
TEL: (310) 834-4868 • FAX: (310) 834-4772

PLM Bulk Asbestos Report

National Econ Corporation
Attn: Danny De La Rosa
730 El Camino Real
Tustin, CA 92780

Date Received 09/26/2003 **SciLab Job No.** 903091499
Date Examined 09/29/2003 **P.O. #** 107311-B
Page 1 of 3
RE: 107311-B; LA Recs & Parks-Encino/Balboa; 16821
Burbank Blvd., Building B

Client No. / HGA	Lab No.	Asbestos Present	Total % Asbestos
EB-A-01	903091499-01 Location: Ceiling Plaster, Men's Restroom Center	Yes	< 1.0%
Description: White/Grey/Yellow, Heterogeneous, Bulk Material Asbestos Types: Chrysotile 1. % Other Material: Non-fibrous 99. %			
EB-A-02	903091499-02 Location: Ceiling Plaster, Women's RR, East by North	Yes	< 1.0%
Description: Beige/Light Grey, Heterogeneous, Bulk Material Asbestos Types: Chrysotile 1. % Other Material: Non-fibrous 99. %			
EB-A-03	903091499-03 Location: Ceiling Plaster, Women's RR, East by North	Yes	3 %
Description: Beige/White, Heterogeneous, Bulk Material Asbestos Types: Chrysotile 3. % Other Material: Non-fibrous 97. %			
EB-A-04	903091499-04 Location: Stucco, Exterior Wall, S. by East	No	NAD
Description: Beige/Grey, Heterogeneous, Bulk Material Asbestos Types: Other Material: Non-fibrous 100. %			
EB-A-05	903091499-05 Location: Stucco, Exterior Wall, E. by South	No	NAD
Description: Beige/Grey, Heterogeneous, Bulk Material Asbestos Types: Other Material: Non-fibrous 100. %			



**SCIENTIFIC LABORATORIES
OF CALIFORNIA, INC.**

24416 SOUTH MAIN STREET • SUITE 308
CARSON, CA 90745
TEL: (310) 834-4868 • FAX: (310) 834-4772

PLM Bulk Asbestos Report

National Econ Corporation
Attn: Danny De La Rosa
730 El Camino Real
Tustin, CA 92780

Date Received 09/26/2003 SciLab Job No. 903091499
Date Examined 09/29/2003 P.O. # 107311-B
Page 2 of 3
RE: 107311-B; LA Recs & Parks-Encino/Balboa; 16821
Burbank Blvd., Building B

Client No. / HGA	Lab No.	Asbestos Present	Total % Asbestos
EB-A-06	903091499-06	No	NAD
Location: Stucco, Exterior Wall, N. by West			
Description: Beige/Grey, Heterogeneous, Bulk Material			
Asbestos Types:			
Other Material: Non-fibrous 100. %			
EB-A-07	903091499-07	Yes	< 1.%
Location: Window Putty, Exterior Windows, S. by East			
Description: Brown/Beige, Heterogeneous, Bulk Material			
Asbestos Types: Chrysotile 1. %			
Other Material: Non-fibrous 99. %			
EB-A-08	903091499-08	Yes	< 1.%
Location: Window Putty, Exterior Windows, S. Center			
Description: Brown/Beige, Heterogeneous, Bulk Material			
Asbestos Types: Chrysotile 1. %			
Other Material: Non-fibrous 99. %			
EB-A-09	903091499-09	Yes	< 1.%
Location: Window Putty, Exterior Windows, S. by West			
Description: Beige/Brown, Heterogeneous, Bulk Material			
Asbestos Types: Chrysotile 1. %			
Other Material: Non-fibrous 99. %			



**SCIENTIFIC LABORATORIES
OF CALIFORNIA, INC.**

24416 SOUTH MAIN STREET • SUITE 308
CARSON, CA 90745
TEL: (310) 834-4868 • FAX: (310) 834-4772

PLM Bulk Asbestos Report

National Econ Corporation
Attn: Danny De La Rosa
730 El Camino Real
Tustin, CA 92780

Date Received 09/26/2003 SciLab Job No. 903091499

Date Examined 09/29/2003 P.O. # 107311-B

Page 3 of 3

RE: 107311-B; LA Recs & Parks-Encino/Balboa; 16821
Burbank Blvd., Building B

Reporting Notes:

Analyzed by: Raymundo Orozco ; Date Analyzed: 9/29/03
*NAD/NSD = no asbestos detected; Detection Limit <1%; Reporting Limits: CVES = 1%, 400 Pt Ct = 0.25%, 1000 Pt Ct = 0.1%; NA = not analyzed; NA/PS = not analyzed / positive stop; PLM Bulk Asbestos Analysis by EPA 600/M4-82-020 per 40 CFR 763 (NVLAP Lab #200346-0, CA ELAP lab #2322); Note: PLM is not consistently reliable in detecting asbestos in floor coverings and similar non-friable organically bound materials. TEM is currently the only method that can be used to determine if this material can be considered or treated as non-asbestos-containing in New York State (also see EPA Advisory for floor tile, FR 59, 146, 38970, 8/1/94). National Institute of Standards and Technology Accreditation requirements mandate that this report must not be reproduced except in full without the approval of the laboratory. This PLM report relates ONLY to the items tested.

Reviewed By: 



SCILAB

**SCIENTIFIC LABORATORIES
OF CALIFORNIA, INC.**

24416 SOUTH MAIN STREET • SUITE 308
CARSON, CA 90745
TEL: (310) 834-4868 • FAX: (310) 834-4772

September 30, 2003

National Econ Corporation
Attn: Danny De La Rosa
730 El Camino Real
Tustin, CA 92780

RE: National Econ Corporation
Job Number 903091497
P.O. # 107311 C&D
107311 C&D; LA Recs & Parks-Encino/Balboa; 16821 Burbank Encino & Balboa C & D

Dear Danny De La Rosa:

Enclosed are the results for PLM asbestos analysis of the following National Econ Corporation samples received at SCILAB on Friday, September 26, 2003, for a 48 hour turnaround:

EB-A-01, EB-A-02, EB-A-03, EB-A-04, EB-A-05, EB-A-06, EB-A-07, EB-A-08, EB-A-09, EB-A-10, EB-A-11, EB-A-12, EB-A-13, EB-A-14, EB-A-15

The 15 samples contained in Ziplock Bags were shipped to SciLab via Hand delivery. These samples were prepared and analyzed according to the EPA Interim Method (EPA 600/M4-82-020 per 40 CFR 763, subpt F, App. A). The required analytical information, analysis results, analyst signature and laboratory identification is contained in the Analyst's Report.

This report relates ONLY to the sample analysis expressed as percent asbestos. SciLab assumes no responsibility for customer supplied data such as "sample type", "location", or "area sampled". This report must not be used to claim product endorsement by SciLab, NVLAP or any agency of the U. S. Government. The National Institute of Standards and Technology Accreditation requirements, mandates that this report must not be reproduced, except in full without the written approval of the laboratory. This report may contain specific data not covered by NVLAP or ELAP accreditations respectively, if so identified in relevant footnotes.

SciLab appreciates this opportunity to serve your organization. Please contact us for any further assistance or with any questions.

Sincerely,



Mary S. De Leon
Customer Service



**SCIENTIFIC LABORATORIES
OF CALIFORNIA, INC.**

24416 SOUTH MAIN STREET • SUITE 308
CARSON, CA 90745
TEL: (310) 834-4868 • FAX: (310) 834-4772

PLM Bulk Asbestos Report

National Econ Corporation
Attn: Danny De La Rosa
730 El Camino Real
Tustin, CA 92780

Date Received 09/26/2003 SciLab Job No. 903091497
Date Examined 09/30/2003 P.O. # 107311 C&D
Page 1 of 4
RE: 107311 C&D; LA Recs & Parks-Encino/Balboa; 16821
Burbank Encino & Balboa C & D

Client No. / HGA	Lab No.	Asbestos Present	Total % Asbestos
EB-A-01	903091497-01 Location: Ceiling Plaster "C", Women's RR, W. By North	Yes	< 1.0%
Description: Beige/White, Heterogeneous, Bulk Material Asbestos Types: Chrysotile 1. % Other Material: Non-fibrous 99. %			
EB-A-02	903091497-02 Location: Ceiling Plaster "C", Men's RR, W. by South	Yes	< 1.0%
Description: Beige, Heterogeneous, Bulk Material Asbestos Types: Chrysotile 1. % Other Material: Non-fibrous 99. %			
EB-A-03	903091497-03 Location: Ceiling Plaster "C", Men's RR, Center by South	Yes	< 1.0%
Description: Beige, Heterogeneous, Bulk Material Asbestos Types: Chrysotile 1. % Other Material: Non-fibrous 99. %			
EB-A-04	903091497-04 Location: Stucco, Front Arcade, N. by East	Yes	< 1.0%
Description: Brown, Heterogeneous, Bulk Material Asbestos Types: Chrysotile 1. % Other Material: Non-fibrous 99. %			
EB-A-05	903091497-05 Location: Stucco, Front Arcade, S. by West	Yes	< 1.0%
Description: Brown, Heterogeneous, Bulk Material Asbestos Types: Chrysotile 1. % Other Material: Non-fibrous 99. %			



**SCIENTIFIC LABORATORIES
OF CALIFORNIA, INC.**

24416 SOUTH MAIN STREET • SUITE 308
CARSON, CA 90745
TEL: (310) 834-4868 • FAX: (310) 834-4772

PLM Bulk Asbestos Report

National Econ Corporation
Attn: Danny De La Rosa
730 El Camino Real
Tustin, CA 92780

Date Received 09/26/2003 SciLab Job No. 903091497
Date Examined 09/30/2003 P.O. # 107311 C&D
Page 2 of 4
RE: 107311 C&D; LA Recs & Parks-Encino/Balboa; 16821
Burbank Encino & Balboa C & D

Client No. / HGA	Lab No.	Asbestos Present	Total % Asbestos
EB-A-06	903091497-06 Location: Stucco, Front Arcade, S. By East	Yes	< 1. %
Description: Brown, Heterogeneous, Bulk Material Asbestos Types: Chrysotile 1. % Other Material: Non-fibrous 99. %			
EB-A-07	903091497-07 Location: A.S.O., Men's Ceiling, NW	Yes	7 %
Description: Beige/White, Heterogeneous, Bulk Material Asbestos Types: Chrysotile 7. % Other Material: Non-fibrous 93. %			
EB-A-08	903091497-08 Location: A.S.O., Men's Ceiling, NW	Yes	7 %
Description: Beige/White, Heterogeneous, Bulk Material Asbestos Types: Chrysotile 7. % Other Material: Non-fibrous 93. %			
EB-A-09	903091497-09 Location: A.S.O., Women's Ceiling, SE	Yes	7 %
Description: Beige/White, Heterogeneous, Bulk Material Asbestos Types: Chrysotile 7. % Other Material: Non-fibrous 93. %			
EB-A-10	903091497-10 Location: CD, Men's Locker Wall, E by N	No	NAD
Description: White, Heterogeneous, Bulk Material Asbestos Types: Other Material: Non-fibrous 100. %			



**SCIENTIFIC LABORATORIES
OF CALIFORNIA, INC.**

24416 SOUTH MAIN STREET • SUITE 308
CARSON, CA 90745
TEL: (310) 834-4868 • FAX: (310) 834-4772

PLM Bulk Asbestos Report

National Econ Corporation
Attn: Danny De La Rosa
730 El Camino Real
Tustin, CA 92780

Date Received 09/26/2003 SciLab Job No. 903091497
Date Examined 09/30/2003 P.O. # 107311 C&D
Page 3 of 4
RE: 107311 C&D; LA Recs & Parks-Encino/Balboa; 16821
Burbank Encino & Balboa C & D

Client No. / HGA	Lab No.	Asbestos Present	Total % Asbestos
EB-A-11	903091497-11 Location: CD, Men's Locker Wall, S by E	No	NAD
Description: Beige/White, Heterogeneous, Bulk Material Asbestos Types: Other Material: Cellulose 20. %, Non-fibrous 80. %			
EB-A-12	903091497-12 Location: CD, Women's Locker Wall, N by E	No	NAD
Description: White, Heterogeneous, Bulk Material Asbestos Types: Other Material: Non-fibrous 100. %			
EB-A-13	903091497-13L1 Location: Cove Base, Men's Locker Wall, NE	No	NAD
Description: Cream, Heterogeneous, Basecove Asbestos Types: Other Material: Non-fibrous 100. %			
EB-A-13	903091497-13L2 Location: Cove Base, Men's Locker Wall, NE	No	NAD
Description: Cream, Heterogeneous, Mastic Asbestos Types: Other Material: Non-fibrous 100. %			
EB-A-14	903091497-14L1 Location: Cove Base, Men's Locker Wall, N by W	No	NAD
Description: Cream, Heterogeneous, Basecove Asbestos Types: Other Material: Non-fibrous 100. %			



**SCIENTIFIC LABORATORIES
OF CALIFORNIA, INC.**

24416 SOUTH MAIN STREET • SUITE 308
CARSON, CA 90745
TEL: (310) 834-4868 • FAX: (310) 834-4772

PLM Bulk Asbestos Report

National Econ Corporation
Attn: Danny De La Rosa
730 El Camino Real
Tustin, CA 92780

Date Received 09/26/2003 **SciLab Job No.** 903091497
Date Examined 09/30/2003 **P.O. #** 107311 C&D
Page 4 **of** 4
RE: 107311 C&D; LA Recs & Parks-Encino/Balboa; 16821
Burbank Encino & Balboa C & D

Client No. / HGA	Lab No.	Asbestos Present	Total % Asbestos
EB-A-14	903091497-14L2 Location: Cove Base, Men's Locker Wall, N by W	No	NAD
Description: Cream, Heterogeneous, Mastic Asbestos Types: Other Material: Non-fibrous 100. %			
EB-A-15	903091497-15L1 Location: Cove Base, Men's Locker Wall, S by W	No	NAD
Description: Cream, Heterogeneous, Basecove Asbestos Types: Other Material: Non-fibrous 100. %			
EB-A-15	903091497-15L2 Location: Cove Base, Men's Locker Wall, S by W	No	NAD
Description: Cream, Heterogeneous, Mastic Asbestos Types: Other Material: Non-fibrous 100. %			

Reporting Notes:

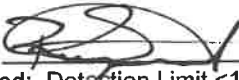
Analyzed by: Raymundo Orozco ; Date Analyzed: 9/30/03
*NAD/NSD = no asbestos detected; Detection Limit <1%; Reporting Limits: CVES = 1%, 400 Pt Ct = 0.25%, 1000 Pt Ct = 0.1%; NA = not analyzed; NA/PS = not analyzed / positive stop; PLM Bulk Asbestos Analysis by EPA 600/M4-82-020 per 40 CFR 763 (NVLAP Lab #200346-0, CA ELAP Lab #2322); Note: PLM is not consistently reliable in detecting asbestos in floor coverings and similar non-friable organically bound materials. TEM is currently the only method that can be used to determine if this material can be considered or treated as non-asbestos-containing in New York State (also see EPA Advisory for floor tile, FR 59, 146, 38970, 8/1/94). National Institute of Standards and Technology Accreditation requirements mandate that this report must not be reproduced except in full without the approval of the laboratory. This PLM report relates ONLY to the items tested.

Reviewed By: 



**SCIENTIFIC LABORATORIES
OF CALIFORNIA, INC.**

24416 SOUTH MAIN STREET • SUITE 308
CARSON, CA 90745
TEL: (310) 834-4868 • FAX: (310) 834-4772

September 29, 2003

National Econ Corporation
Attn: Danny De La Rosa
730 El Camino Real
Tustin, CA 92780

RE: National Econ Corporation
Job Number 903091501
P.O. # 107311-E
107311-E; LA Recs & Parks-Encino/Balboa; 16821 Burbank Blvd., Building E

Dear Danny De La Rosa:

Enclosed are the results for PLM asbestos analysis of the following National Econ Corporation samples received at SCILAB on Friday, September 26, 2003, for a 48 hour turnaround:

EB-A-01, EB-A-02, EB-A-03, EB-A-04, EB-A-05, EB-A-06, EB-A-07, EB-A-08, EB-A-09, EB-A-10, EB-A-11, EB-A-12, EB-A-13

The 13 samples contained in Ziplock Bags were shipped to SciLab via Hand delivery. These samples were prepared and analyzed according to the EPA Interim Method (EPA 600/M4-82-020 per 40 CFR 763, subpt F, App. A). The required analytical information, analysis results, analyst signature and laboratory identification is contained in the Analyst's Report.

This report relates ONLY to the sample analysis expressed as percent asbestos. SciLab assumes no responsibility for customer supplied data such as "sample type", "location", or "area sampled". This report must not be used to claim product endorsement by SciLab, NVLAP or any agency of the U. S. Government. The National Institute of Standards and Technology Accreditation requirements, mandates that this report must not be reproduced, except in full without the written approval of the laboratory. This report may contain specific data not covered by NVLAP or ELAP accreditations respectively, if so identified in relevant footnotes.

SciLab appreciates this opportunity to serve your organization. Please contact us for any further assistance or with any questions.

Sincerely,

Mary S. De Leon
Customer Service



**SCIENTIFIC LABORATORIES
OF CALIFORNIA, INC.**

24416 SOUTH MAIN STREET • SUITE 308
CARSON, CA 90745
TEL: (310) 834-4868 • FAX: (310) 834-4772

PLM Bulk Asbestos Report

National Econ Corporation
Attn: Danny De La Rosa
730 El Camino Real
Tustin, CA 92780

Date Received 09/26/2003 SciLab Job No. 903091501
Date Examined 09/29/2003 P.O. # 107311-E
Page 1 of 4
RE: 107311-E; LA Recs & Parks-Encino/Balboa; 16821
Burbank Blvd., Building E

Client No. / HGA	Lab No.	Asbestos Present	Total % Asbestos
EB-A-01	903091501-01 Location: Plaster, Men's Room, NW	No	NAD
Description: Grey, Heterogeneous, Bulk Material Asbestos Types: Other Material: Non-fibrous 100. %			
EB-A-02	903091501-02 Location: Plaster, Men's Room, NW	No	NAD
Description: Grey, Heterogeneous, Bulk Material Asbestos Types: Other Material: Non-fibrous 100. %			
EB-A-03	903091501-03 Location: Plaster, Men's Room, W. Center	No	NAD
Description: Beige/Grey, Heterogeneous, Bulk Material Asbestos Types: Other Material: Non-fibrous 100. %			
EB-A-04	903091501-04 Location: Stucco, Ext. SE	No	NAD
Description: Beige/Grey, Heterogeneous, Bulk Material Asbestos Types: Other Material: Non-fibrous 100. %			
EB-A-05	903091501-05 Location: Stucco, Ext. NE	No	NAD
Description: Beige/Grey, Heterogeneous, Bulk Material Asbestos Types: Other Material: Non-fibrous 100. %			



**SCIENTIFIC LABORATORIES
OF CALIFORNIA, INC.**

24416 SOUTH MAIN STREET • SUITE 308
CARSON, CA 90745
TEL: (310) 834-4868 • FAX: (310) 834-4772

PLM Bulk Asbestos Report

National Econ Corporation
Attn: Danny De La Rosa
730 El Camino Real
Tustin, CA 92780

Date Received 09/26/2003 SciLab Job No. 903091501
Date Examined 09/29/2003 P.O. # 107311-E
Page 2 of 4
RE: 107311-E; LA Recs & Parks-Encino/Balboa; 16821
Burbank Blvd., Building E

Client No. / HGA	Lab No.	Asbestos Present	Total % Asbestos
EB-A-06 Location: Stucco, Ext. NW Description: Beige/Grey, Heterogeneous, Bulk Material Asbestos Types: Other Material: Non-fibrous 100. %	903091501-06	No	NAD
EB-A-07 Location: Cement Board, Ext. Men's Room Description: Blue/Grey, Heterogeneous, Bulk Material Asbestos Types: Chrysotile 40. % Other Material: Non-fibrous 60. %	903091501-07	Yes	40 %
EB-A-08 Location: Capsheet Built-Up Roofing, SE Roof Description: Black/Grey, Heterogeneous, Roofing Asbestos Types: Other Material: Cellulose 40. %, Non-fibrous 60. %	903091501-08.1	No	NAD
EB-A-08 Location: Capsheet Built-Up Roofing, SE Roof Description: Brown, Heterogeneous, Roofing Asbestos Types: Other Material: Cellulose 100. %	903091501-08.2	No	NAD
EB-A-09 Location: Capsheet Built-Up Roofing, Center Roof Description: Black/Grey, Heterogeneous, Roofing Asbestos Types: Other Material: Cellulose 40. %, Non-fibrous 60. %	903091501-09.1	No	NAD



**SCIENTIFIC LABORATORIES
OF CALIFORNIA, INC.**

24416 SOUTH MAIN STREET • SUITE 308
CARSON, CA 90745
TEL: (310) 834-4868 • FAX: (310) 834-4772

PLM Bulk Asbestos Report

National Econ Corporation
Attn: Danny De La Rosa
730 El Camino Real
Tustin, CA 92780

Date Received 09/26/2003 SciLab Job No. 903091501
Date Examined 09/29/2003 P.O. # 107311-E
Page 3 of 4
RE: 107311-E; LA Recs & Parks-Encino/Balboa; 16821
Burbank Blvd., Building E

Client No. / HGA	Lab No.	Asbestos Present	Total % Asbestos
EB-A-09	903091501-09.2 Location: Capsheet Built-Up Roofing, Center Roof	No	NAD
Description: Brown, Heterogeneous, Roofing Asbestos Types: Other Material: Cellulose 100. %			
EB-A-10	903091501-10.1 Location: Capsheet Built-Up Roofing, NW Roof	No	NAD
Description: Black/Grey, Heterogeneous, Roofing Asbestos Types: Other Material: Cellulose 40. %, Non-fibrous 60. %			
EB-A-10	903091501-10.2 Location: Capsheet Built-Up Roofing, NW Roof	No	NAD
Description: Brown, Heterogeneous, Roofing Asbestos Types: Other Material: Cellulose 100. %			
EB-A-11	903091501-11 Location: Roof Mastic, Roof, SE	No	NAD
Description: Black, Heterogeneous, Bulk Material Asbestos Types: Other Material: Cellulose 20. %, Fibrous glass 10. %, Non-fibrous 70. %			
EB-A-12	903091501-12 Location: Roof Mastic, Roof, SE	No	NAD
Description: Black, Heterogeneous, Bulk Material Asbestos Types: Other Material: Cellulose 20. %, Fibrous glass 5. %, Non-fibrous 75. %			



**SCIENTIFIC LABORATORIES
OF CALIFORNIA, INC.**

24416 SOUTH MAIN STREET • SUITE 308
CARSON, CA 90745
TEL: (310) 834-4868 • FAX: (310) 834-4772

PLM Bulk Asbestos Report

National Econ Corporation
Attn: Danny De La Rosa
730 El Camino Real
Tustin, CA 92780

Date Received 09/26/2003 SciLab Job No. 903091501
Date Examined 09/29/2003 P.O. # 107311-E
Page 4 of 4
RE: 107311-E; LA Recs & Parks-Encino/Balboa; 16821
Burbank Blvd., Building E

Client No. / HGA	Lab No.	Asbestos Present	Total % Asbestos
EB-A-13	903091501-13	Yes	7 %

Location: Roof Mastic, Roof, SW

Description: Black/Grey, Heterogeneous, Bulk Material
Asbestos Types: Chrysotile 7. %
Other Material: Non-fibrous 93. %

Reporting Notes:

Analyzed by: Raymundo Orozco ; Date Analyzed: 9/29/03
*NAD/NSD = no asbestos detected; Detection Limit <1%; Reporting Limits: CVES = 1%, 400 Pt Ct = 0.25%, 1000 Pt Ct = 0.1%; NA = not analyzed; NA/PS = not analyzed / positive stop; PLM Bulk Asbestos Analysis by EPA 600/M4-82-020 per 40 CFR 763 (NVLAP Lab #200346-0, CA ELAP lab #2322); Note: PLM is not consistently reliable in detecting asbestos in floor coverings and similar non-friable organically bound materials. TEM is currently the only method that can be used to determine if this material can be considered or treated as non-asbestos-containing in New York State (also see EPA Advisory for floor tile, FR 59, 146, 38970, 8/1/94). National Institute of Standards and Technology Accreditation requirements mandate that this report must not be reproduced except in full without the approval of the laboratory. This PLM report relates ONLY to the items tested.

Reviewed By: 



**SCIENTIFIC LABORATORIES
OF CALIFORNIA, INC.**

24416 SOUTH MAIN STREET • SUITE 308
CARSON, CA 90745
TEL: (310) 834-4868 • FAX: (310) 834-4772

September 29, 2003

National Econ Corporation
Attn: Danny De La Rosa
730 El Camino Real
Tustin, CA 92780

RE: National Econ Corporation
Job Number 903091498
P.O. # 107311-F
107311-F; LA Recs & Parks-Encino/Balboa; 16821 Burbank Rd., Building F

Dear Danny De La Rosa:

Enclosed are the results for PLM asbestos analysis of the following National Econ Corporation samples received at SCILAB on Friday, September 26, 2003, for a 48 hour turnaround:

311-F-01, 311-F-02, 311-F-03, 311-F-04, 311-F-05, 311-F-06, 311-F-07, 311-F-08, 311-F-09

The 9 samples contained in Ziplock Bags were shipped to SciLab via Hand delivery. These samples were prepared and analyzed according to the EPA Interim Method (EPA 600/M4-82-020 per 40 CFR 763, subpt F, App. A). The required analytical information, analysis results, analyst signature and laboratory identification is contained in the Analyst's Report.

This report relates ONLY to the sample analysis expressed as percent asbestos. SciLab assumes no responsibility for customer supplied data such as "sample type", "location", or "area sampled". This report must not be used to claim product endorsement by SciLab, NVLAP or any agency of the U. S. Government. The National Institute of Standards and Technology Accreditation requirements, mandates that this report must not be reproduced, except in full without the written approval of the laboratory. This report may contain specific data not covered by NVLAP or ELAP accreditations respectively, if so identified in relevant footnotes.

SciLab appreciates this opportunity to serve your organization. Please contact us for any further assistance or with any questions.

Sincerely,

Mary S. De Leon
Customer Service



**SCIENTIFIC LABORATORIES
OF CALIFORNIA, INC.**

24416 SOUTH MAIN STREET • SUITE 308
CARSON, CA 90745
TEL: (310) 834-4868 • FAX: (310) 834-4772

PLM Bulk Asbestos Report

National Econ Corporation
Attn: Danny De La Rosa
730 El Camino Real
Tustin, CA 92780

Date Received 09/26/2003 SciLab Job No. 903091498

Date Examined 09/29/2003 P.O. # 107311-F

Page 1 of 3

RE: 107311-F; LA Recs & Parks-Encino/Balboa; 16821
Burbank Rd., Building F

Client No. / HGA	Lab No.	Asbestos Present	Total % Asbestos
311-F-01	903091498-01	No	NAD
Location: Rock Built-Up Roofing, South Center-Roof			
Description: Black, Heterogeneous, Bulk Material			
Asbestos Types:			
Other Material: Cellulose 20. %, Non-fibrous 80. %			
311-F-02	903091498-02	No	NAD
Location: Rock Built-Up Roofing, Center Center-Roof			
Description: Black, Heterogeneous, Bulk Material			
Asbestos Types:			
Other Material: Cellulose 30. %, Non-fibrous 70. %			
311-F-03	903091498-03	No	NAD
Location: Rock Built-Up Roofing, Northeast-Roof			
Description: Black, Heterogeneous, Bulk Material			
Asbestos Types:			
Other Material: Cellulose 30. %, Non-fibrous 70. %			
311-F-04	903091498-04	Yes	5 %
Location: Roof Mastic, Roof S. Center			
Description: Black/Grey, Heterogeneous, Bulk Material			
Asbestos Types: Chrysotile 5. %			
Other Material: Non-fibrous 95. %			
311-F-05	903091498-05	Yes	5 %
Location: Roof Mastic, Roof N. Center			
Description: Black, Heterogeneous, Bulk Material			
Asbestos Types: Chrysotile 5. %			
Other Material: Non-fibrous 95. %			



**SCIENTIFIC LABORATORIES
OF CALIFORNIA, INC.**

24416 SOUTH MAIN STREET • SUITE 308
CARSON, CA 90745
TEL: (310) 834-4868 • FAX: (310) 834-4772

PLM Bulk Asbestos Report

National Econ Corporation
Attn: Danny De La Rosa
730 El Camino Real
Tustin, CA 92780

Date Received 09/26/2003 **SciLab Job No.** 903091498
Date Examined 09/29/2003 **P.O. #** 107311-F
Page 2 of 3
RE: 107311-F; LA Recs & Parks-Encino/Balboa; 16821
Burbank Rd., Building F

Client No. / HGA	Lab No.	Asbestos Present	Total % Asbestos
311-F-06	903091498-06	Yes	5 %
Location: Roof Mastic, Roof Center Center			
Description: Black/Grey, Heterogeneous, Bulk Material			
Asbestos Types: Chrysotile 5. %			
Other Material: Non-fibrous 95. %			
311-F-07	903091498-07	No	NAD
Location: Plaster Walls, Women, 1st Stall Wall			
Description: Beige, Heterogeneous, Bulk Material			
Asbestos Types:			
Other Material: Non-fibrous 100. %			
311-F-08	903091498-08	No	NAD
Location: Plaster Walls, Women's 2nd Stall Wall			
Description: Beige, Heterogeneous, Bulk Material			
Asbestos Types:			
Other Material: Non-fibrous 100. %			
311-F-09	903091498-09	No	NAD
Location: Plaster Walls, Men's Ceiling D-Side			
Description: Beige, Heterogeneous, Bulk Material			
Asbestos Types:			
Other Material: Non-fibrous 100. %			



**SCIENTIFIC LABORATORIES
OF CALIFORNIA, INC.**

24416 SOUTH MAIN STREET • SUITE 308
CARSON, CA 90745
TEL: (310) 834-4868 • FAX: (310) 834-4772

PLM Bulk Asbestos Report

National Econ Corporation
Attn: Danny De La Rosa
730 El Camino Real
Tustin, CA 92780

Date Received 09/26/2003 SciLab Job No. 903091498
Date Examined 09/29/2003 P.O. # 107311-F
Page 3 of 3
RE: 107311-F; LA Recs & Parks-Encino/Balboa; 16821
Burbank Rd., Building F

Reporting Notes:

Analyzed by: Raymundo Orozco ; Date Analyzed: 9/29/03
*NAD/NSD = no asbestos detected; Defection Limit <1%; Reporting Limits: CVES = 1%, 400 Pt Ct = 0.25%, 1000 Pt Ct = 0.1%; NA = not analyzed; NA/PS = not analyzed / positive stop; PLM Bulk Asbestos Analysis by EPA 600/M4-82-020 per 40 CFR 763 (NVLAP Lab #200346-0, CA ELAP lab #2322); Note: PLM is not consistently reliable in detecting asbestos in floor coverings and similar non-friable organically bound materials. TEM is currently the only method that can be used to determine if this material can be considered or treated as non-asbestos-containing in New York State (also see EPA Advisory for floor tile, FR 59, 146, 38970, 8/1/94). National Institute of Standards and Technology Accreditation requirements mandate that this report must not be reproduced except in full without the approval of the laboratory. This PLM report relates ONLY to the items tested.

Reviewed By: 